

TECHNICAL MANUAL

ORGANIZATIONAL MAINTENANCE
REPAIR PARTS AND SPECIAL TOOLS LIST
FOR
BATTERY COMPUTER SYSTEM AN/GYK-29(V)

HEADQUARTERS, DEPARTMENT OF THE ARMY

28 MAY 1985

TECHNICAL MANUAL }
 No. 11-7440-283-20P }

HEADQUARTERS
 DEPARTMENT OF THE ARMY
 WASHINGTON, DC 28 May 1985

ORGANIZATIONAL MAINTENANCE
 REPAIR PARTS AND SPECIAL TOOLS LIST
 FOR

BATTERY COMPUTER SYSTEM AN/GYK-29(v)
 Current as of 1 February 1985

REPORTING ERRORS AND RECOMMENDING IMPROVEMENTS

You can help improve this manual. If you find any mistakes or if you know of a way to improve the procedures, please let us know. Mail your letter, DA Form 2028 (Recommended Changes to Publications and Blank Forms), or DA Form 2028-2 located in back of this manual direct to: Commander, US Army Communications-Electronics Command and Fort Monmouth, ATTN: AMSEL-ME-MP, Fort Monmouth, NJ 07703-5007,

In either case, a reply will be furnished direct to you.

Table of Contents

		Page	Illus Figure
SECTION	I. Introduction	1	
	II. Repair Parts List	1-1	
GROUP	00 Battery Computer System, AN/GYK-29(V).	1-1	1
	01 Computer Group, Gun Direction OL-200/GYK-29(V)	2-1	2
	0101 Computer, Gun Direction CP-1317/GYK-29(V).	3-1	3
	010111 Front Panel Assembly	16-1	16
	01011102 Control Panel Assembly	23-1	23
	010115 Housing Assembly.. . . .	25-1	25
	01011502 Comm Channel Filter Assembly	27-1	27
	0102 Tape Transport. Unit RD-439/GYK-29(v)	28-1	28
	0103 Power Distribution Group ON-188/GYK-2S(v).	29-1	29
	010301 Power Distribution Unit	30-1	30
	0104 Interconnecting Kit MK-1829/GYK-29(V).	31-1	31
	0105 Mounting Base, Computer Gun Direction MT-4938/GYK-29(v)	32-1	32
	02 Data Display Group, Gun Direction OD-144(V)/GYK-29g(v)	33-1	33
	020103 Housing Assembly, SCA	37-1	37
	020202 Housing Assembly,GA	40-1	40
	02030101 Power Supply Unit Chassis Assy	44-1	44
SECTION	III. Special Tool List (Not applicable)		
GROUP	30 Special Tools.	50-1	50
SECTION	IV. National Stock Number and part Number Index	1-1	

SECTION I

I N T R O D U C T I O N

1. Scope

This manual lists and authorizes spares and repair parts; special tools; special test, measurement, and diagnostic equipment (TMDE); and other special support equipment required for performance of organizational maintenance of the AN/GYK-29(V). It authorizes the requisitioning, issue, and disposition of spares, repair parts and special tools as indicated by the source, maintenance and recoverability (SMR) codes,

2. General

This Repair Parts and Special Tools List is divided into the following sections:

- a. *Section II Repair Parts List.* A list of spares and repair parts authorized by this RPSTL for use in the performance of maintenance. The list also includes parts which must be removed for replacement of the authorized parts. Parts lists are composed of functional groups in ascending numeric sequence, with the parts in each group listed in ascending item number sequence. Figure numbers are listed directly beneath the group header.
- b. *Section III. Special Tool list.* A list of special tools, special TMDE, and other special support equipment authorized by this RPSTL (as indicated by Basis of Issue (BOI) information in (column (5)) for the performance of maintenance.
- c. *Section IV. National Stock Number and Part Number Index.* A list, in National item identification number (NIIN) sequence, of all National stock numbered items appearing in the listing, followed by a list in alphameric sequence of all part numbers appearing in the listings. National stock numbers and part numbers are cross-referenced to each illustration figure and item number appearance.

3. Explanation of Columns (Section II and III)

- a. *Item No. (Column (1)).* Indicates the number used to identify items called out in the illustration.
- b. *SMR Code (Column (2)).* The source, maintenance, and recoverability (SMR) code is a five-position code containing supply/requisitioning information, maintenance category authorization criteria, and disposition instruction, as shown in the following breakout:

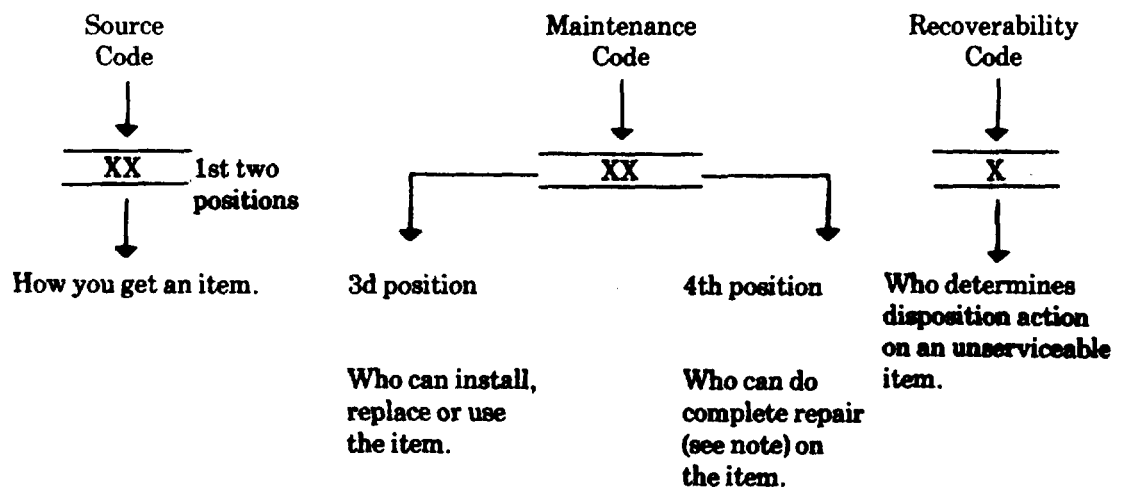

NOTE

Complete repair: Maintenance capacity, capability, and authority to perform all corrective maintenance tasks of the "Repair" function in a usduser environment in order to restore serviceability to a failed item.

(1) *Source code.* The source code tells you how to get an item needed for maintenance, repair, or overhaul of an end item/equipment. Explanations of source codes follows:

<i>code</i>	<i>Explanation</i>
<div style="border: 1px solid black; padding: 5px; display: inline-block;"> PA PB PC PD PE PF PG </div>	<p>Stocked items; use the applicable NSN to request/requisition items with these source codes. They are authorized to the category indicated by the code entered in the third position of the SMR code.</p> <p style="text-align: center;">NOTE Items coded PC are subject to deterioration.</p>
<div style="border: 1px solid black; padding: 5px; display: inline-block;"> KD KF KB </div>	<p>Items with these codes are not to be requested/requisitioned individually. They are part of a kit which is authorized to the maintenance category indicated in the third position of the SMR code. The complete kit must be requisitioned and applied.</p>

<div style="border: 1px solid black; padding: 5px; display: inline-block;"> MO—Made at org/AVUM category MF—Made at DS/AVUM category MH—Made at GS category ML—Made at Specialized Repair Activity (SRA) MD—Made Depot </div>	<p>Items with these codes are not to be requested/requisitioned individually. They must be made from bulk material which is identified by the part number in the description and usable on code (UOC) column and listed in the Bulk Material group of the repair parts list. If the item is authorized to you by the third position code of the SMR code, but the source code indicates it is made at a higher category, order the item from the higher category of maintenance.</p>
---	--

<div style="border: 1px solid black; padding: 5px; display: inline-block;"> AO—Assembled by org/AVUM category AF—Assembled by DS/AVIM category AH—Assembled by GS category AL—Assembled by SRA AD—Assembled by Depot </div>	<p>Items with these codes are not to be request/requisitioned individually. The parts that make up the assembled item must be requisitioned or fabricated and assembled at the category of maintenance indicated by the source code, If the disposition code of the SMR code authorizes you to replace the item, but the source code indicates the item is assembled at a higher category, order the item from the higher category of maintenance.</p>
---	--

<i>Code</i>	<i>Explanation</i>
XA	DO not requisition an "XA" coded item. Order its next higher assembly.
XB	If an "XB" item is not available from salvage, order it using the FSCM and part number given.
XC	Installation drawing, diagram, instruction sheet, field service drawing, that is identified by manufacturers part number.
XD	Item is not stocked. Order an "XD" coded item through normal supply channels using the FSCM and part number given, if no NSN is available.

NOTE

Cannibalization or controlled exchange, when authorized, may be used as a source of supply for items with the above source codes, except for those source coded "XA" or those aircraft support items restricted by requirements of AR 750-1.

(2) *Maintenance code.* Maintenance codes tell you the category of maintenance authorized to USE and REPAIR support items. The maintenance codes are entered in the third and fourth positions of the SMR code as follows:

(a) The maintenance code entered in the third position tells you the lowest maintenance category authorized

to remove, replace, and use an item. The maintenance code entered in the third position will indicate authorization to one of the following categories of maintenance.

<i>Code</i>	<i>Application/Explanation</i>
C	Crew or operator maintenance done within organizational or aviation maintenance.
O	Organizational or aviation unit category can remove, replace, and use the item.
F	Direct support or aviation intermediate category can remove, replace, and use the item.
H	General support category can remove, replace, and use the item.
L	Specialized repair activity can remove, replace, and use the item.
D	Depot category can remove, replace, and use the item.

(b) The maintenance code entered in the fourth position tells whether or not the item is to be repaired and identifies the lowest maintenance category with the capability to do complete repair (i.e., perform all authorized repair functions). This position will contain one of the following maintenance codes.

NOTE

Some limited repair may be done on the item at a lower category of maintenance, if authorized by the Maintenance Allocation Chart (MAC) and SMR codes.

<i>Code</i>	<i>Application/Explanation</i>
O	Organizational or aviation unit is the lowest category that can do complete repair of the item.
F	Direct support or aviation intermediate is the lowest category that can do complete repair of the item.
H	General support is the lowest category that can do complete repair of the item.
L	Specialized repair activity (designate the specialized repair activity) is the lowest category that can do complete repair of the item.
D	Depot is the lowest category that can do complete repair of the item.
Z	Nonreparable. No repair is authorized.
B	No repair is authorized. (No parts or special tools are authorized for the maintenance of a "B" coded item). However, the item may be reconditioned by adjusting, lubricating, etc., at the user category.

(3) Recoverability code. Recoverability codes are assigned to items to indicate the disposition action on unserviceable items. The recoverability code is entered in the fifth position of the SMR Code as follows:

<i>Recoverability Codes</i>	<i>Application/Explanation</i>
Z	Nonreparable Item. When unserviceable, condemn and dispose of the item at the category of maintenance shown in the third position of SMR Code.
O	Reparable item. When uneconomically repairable, condemn and dispose of the item at organizational or aviation unit category.
F	Reparable item. When uneconomically repairable, condemn and dispose of the item at direct support or aviation intermediate category.
H	Reparable item. When uneconomically repairable, condemn and dispose of the item at general support category.
D	Reparable item. When beyond lower category repair capability, return to depot, Condemnation and disposal of item not authorized below depot category.
L	Reparable item. Condemnation and disposal not authorized below specialized repair activity (SRA).
A	Item requires special handling or condemnation procedures because of specific reasons (e.g., precious metal content, high dollar valve, critical material, or hazardous material). Refer to appropriate manuals/directives for specific instructions.

c. FSCM (*Column (3)*). The Federal Supply Code for Manufacturer (FSCM) is a 5-digit numeric code which is used to identify the manufacturer, distributor, or Government agency, etc., that supplies the item.

d. *Part Number (Column (4))*. Indicates the primary number used by the manufacturer (individual, company, firm, corporation, or Government activity), which controls the design and characteristics of the item by means of its engineering drawings, specifications, standards, and inspection requirements to identify an item or range of items,

NOTE

When you use a NSN to requisition an item, the item you receive may have a different part number from the part ordered.

e. *Description and Usable on Code (UOC) (Column (5))*. This column includes the following information.

- (1) The Federal item name and, when required, a minimum description to identify the item.
- (2) Usable encode, when applicable (para 5).
- (3) In the Special Tools section, the basis of issue (BOI) appears as the last line in the entry for each special tool, special TMDE, and other special support equipment. When density of equipments supported exceeds density spread indicated in the basis of issue, the total authorization is increased proportionately.

(4) The statement "END OF FIGURE" appears just below the last item description in Column (5) for a given figure in both section II and section III.

f. *Qty (Column (6)).* Indicates the quantity of the item used in the breakout shown on the illustration figure, which is prepared for a functional group, subfunctional group, or an assembly. A "V" appearing in this column in lieu of a quantity indicates that the quantity is variable and the quantity may vary from application to application.

4. Explanation of Columns (Section IV)

a. *National Stock Number (NSN) Index.*

(1) *Stock number column.* This column lists the NSN by National item identification number (NIIN) sequence. The NIIN consists of the last nine digits of the NSN. When using this column to locate an item, ignore the first four digits of the NSN. When requisitioning items use the complete NSN (13 digits).

(2) *Fig. column.* This column lists the number of the figure where the item is identified/located. The illustrations are in numerical sequence in sections II and III.

(3) *Item column.* The item number identifies the item associated with the figure listed in the adjacent Fig. column. This item is also identified by the NSN listed on the same line.

b. *Part Number Index.* Part numbers in this index are listed by part number in ascending alphameric sequence.

(1) *FSCM column.* This column lists the Federal supply code for manufacturer (FSCM).

(2) *Part number column.* This column indicates the part number assigned to the item.

(3) *Stock number column.* This column lists the National stock number for the associated part number and manufacturer identified in the part number and FSCM columns to the left.

(4) *Fig. column.* This column lists the number of the figure where the item is identified/located in section II and III.

(5) *Item column.* The item number is that number assigned to the item as it appears in the figure referenced in the adjacent figure number column.

5. Special Information

a. *Usable on Code.* The usable on code appears in the lower left corner of the description column heading. Usable on codes are shown as "UOC:" in the description column (justified left) on the line line applicable item description nomenclature. Uncoded items are applicable to all models. Identification of the usable on codes used in this RPSTL are:

<i>Code</i>	<i>Used on</i>
ELZ	CP-1317/GYK-29
ENM	ON-188/GYK-29
EPB	RD-439/GYK-29
EPC	MK-18291GYK-29
EPD	MT-4938/GYK-29
EL2	MK-18311GYK-29
EL3	MK-1832/GYK-29
EL4	OD-144(V)1/GYK-29
FFC	OL-200/GYK-29
FH4	OD-144(V)2/GYK-29
FH5	OD-144(V)WGYK-29

b. *Associated Publications.* The publications listed below pertain to the AN/GYK-29(V) and its components:

- TM 11-7440-283-12, Computer System, Gun Direction AN/GYK-29
- TM 11-7440-283-12-1, Computer Group, Gun Direction OL-200/GYK-29(V)
- TM 11-7440-283-12-1-1, Computer Group, Gun Direction OL-200/GYK-29(V)
- TM 11-7440-283-12-2, Data Display Group, Gun Direction OD-144/GYK-29(V)

c. *Illustrations—Listing.* The illustrations in this RPSTL are identical to those published in TM 11-7440-283-40P. Only those parts coded "C" or "O" in the third position of the SMR code are listed in the tabular listing; therefore, there may be a break in the item number sequence, figure number and page number. Only illustrations containing organizational or aviation unit authorized items appear in this RPSTL.

d. *National Stock Numbers.* National stock numbers (NSN'S) that are missing from P source coded items have been applied for and will be added to this TM by future change/revision when they are entered in the Army Master Data File (AMDF). Until the NSN's are established and published, submit exception requisitions to: Commander, US Army Communications-Electronics Command and Fort Monmouth, ATTN: AMSEL-MM, Fort Monmouth, NJ 07703-5006 for the part required to support your equipment.

6. How to Locate Repair Parts

a. When National stock number or part number is not known.

(1) *First.* Using the table of contents, determine the assembly group or subassembly group to which the item belongs. This is necessary since figures are prepared for assembly groups and subassembly groups, and listings are divided into the same groups.

(2) *Second.* Find the figure covering the assembly group or subassembly group to which the item belongs,

(3) *Third.* Identify the item on the figure and note the item number.

(4) *Fourth.* Refer to the Repair Parts List for the figure to find the part number for the item number noted on the figure.

(5) *Fifth.* Refer to the Part Number Index to find the NSN, if assigned.

b. When National stock number or part number is known.

(1) *First.* Using the index of National stock numbers and part numbers, find the pertinent National stock number or part number. The NSN index is in National item identification number (NIIN) sequence (para 4a(1)). The part numbers in the part number index are listed in ascending alphameric sequence (para 4b). Both indexes cross-reference you to the illustration figure and item number of the item you are looking for.

(2) *Second.* After finding the figure and item number, verify that the item is the one you're looking for, then locate the item number in the repair parts list for the figure,

7. Abbreviations

Not applicable.

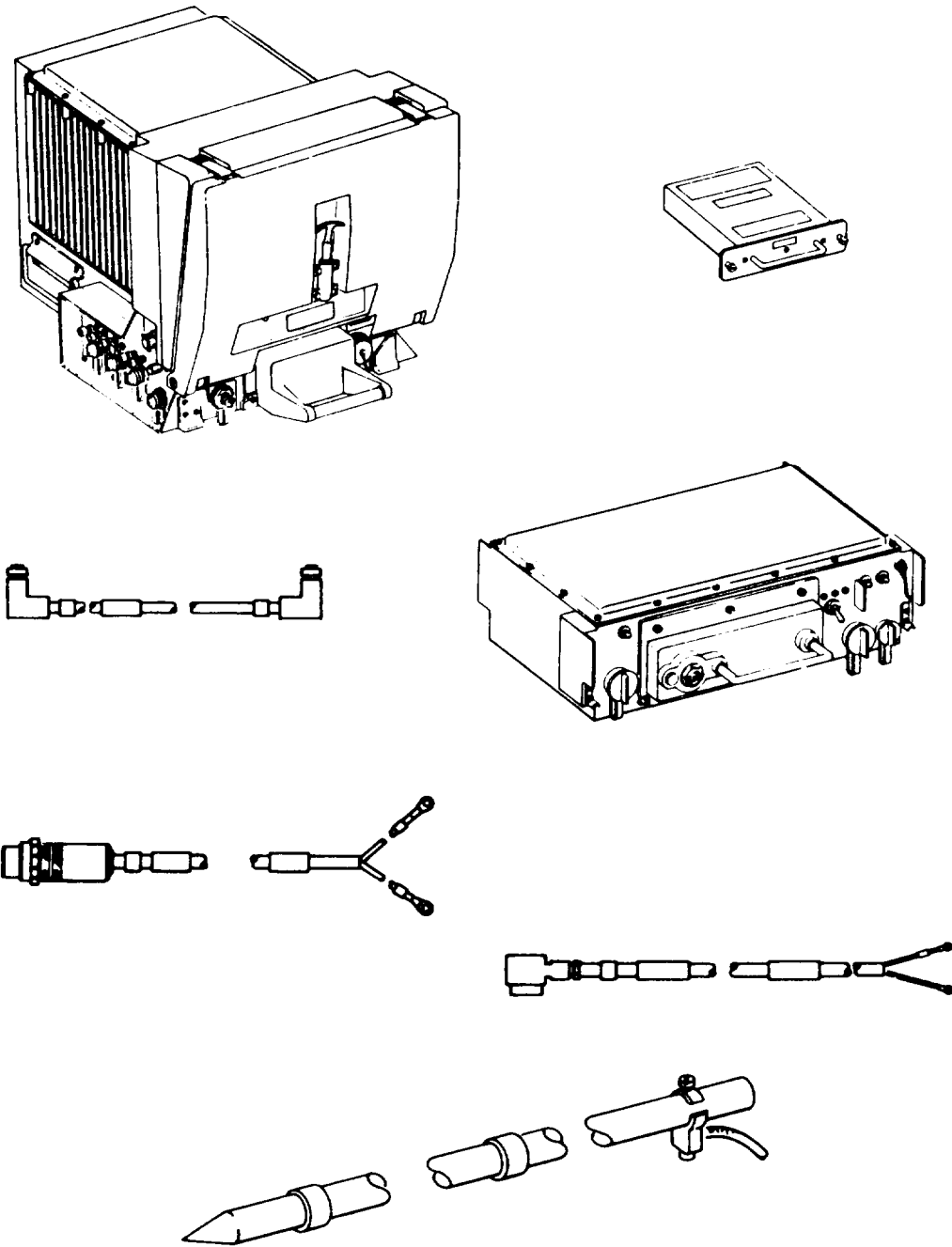

EL5BE001

Figure 1. Complete System, Gun Direction AN/GYK-29(V) (SHEET 1 OF 5)

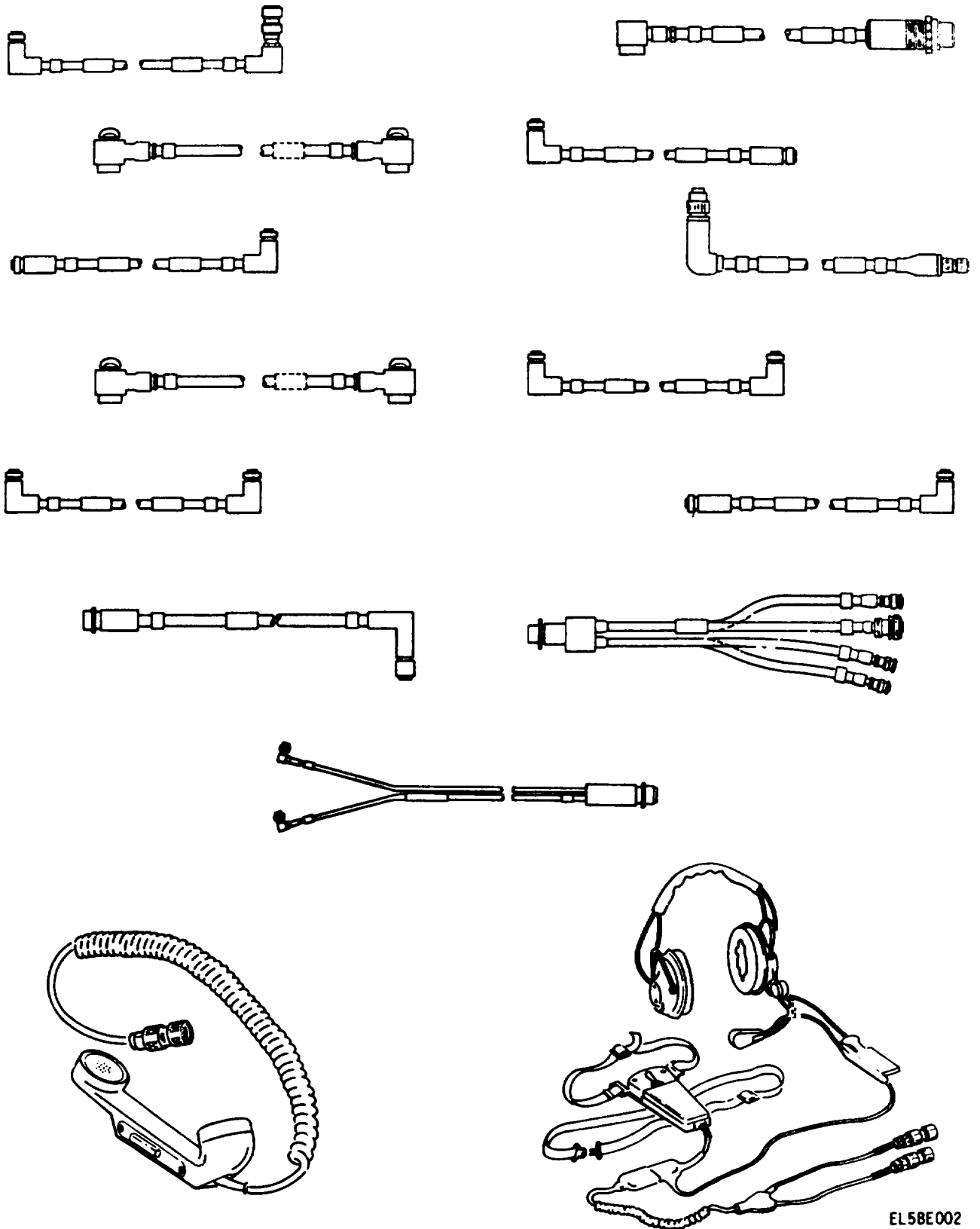
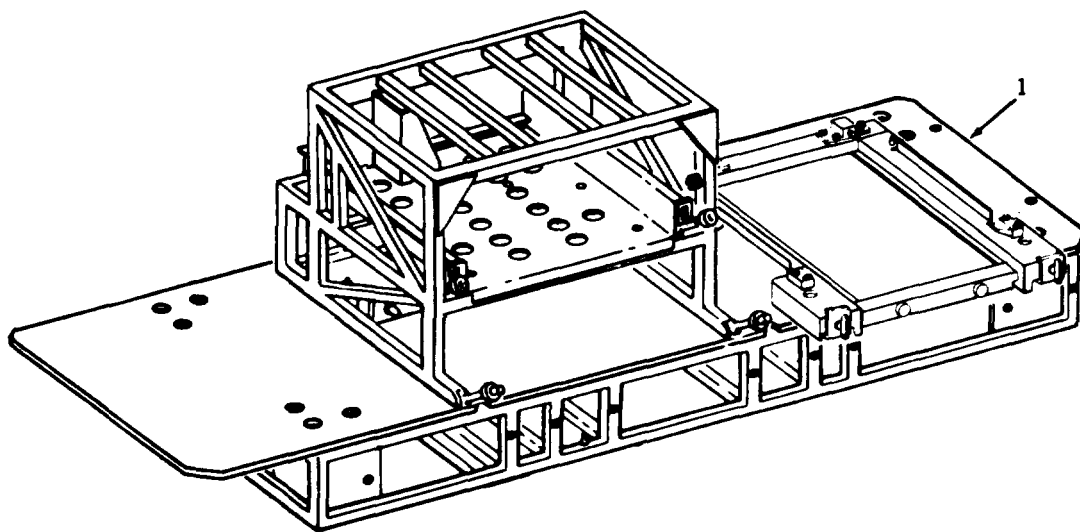
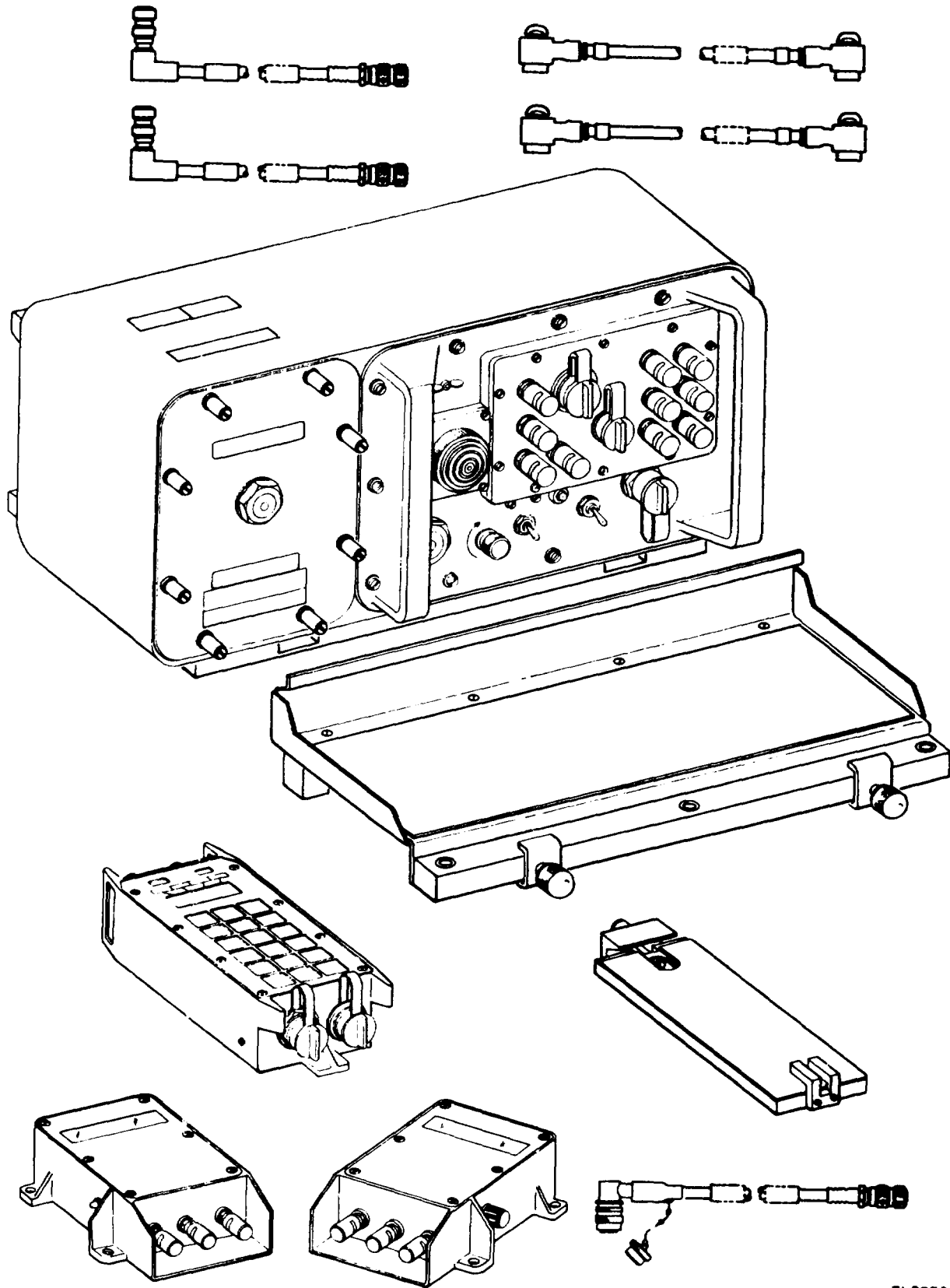

Figure 1. Computer System, Gun Direction AN/GYK-29(V) (Sheet 2 of 5)



EL5BE003

Figure 1. Computer System, Gun Direction AN/GYK-29(v) (Sheet 3 of 5)



EL58E005

Figure 1. Computer System, Gun Direction AN/GYK-29(v) (Sheet 4 of 5)

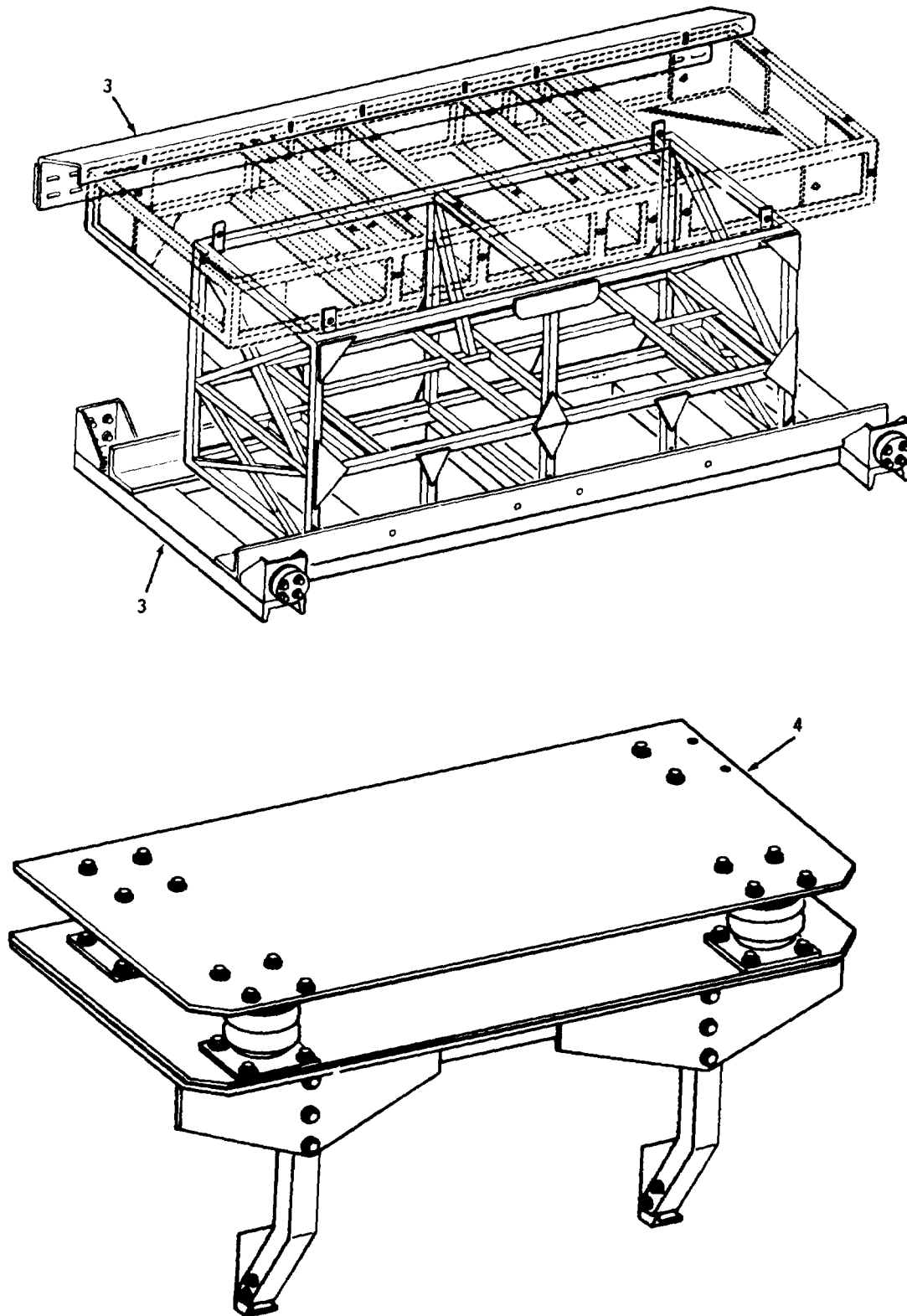

EL58E004

Figure 1. computer System, Gun Direction AN/GYK-29(V) (sheet 5 of 5)

SECTION II		TM11-7440-283-20P				
(1)	(2)	(3)	(4)	(5)	(6)	
ITEM NO.	SMR CODE	FSCM	PART NUMBER	DESCRIPTION AND USABLE ON CODE (UOC)	QTY	
GROUP 00 BATTERY COMPUTER SYSTEM AN/GYK-29						
FIGURE 1						
1	PDODD	80058	OL-200/GYK-29 (V)	COMPUTER GROUP,GUN	1	
2	PDODD	80058	OD-144(V)/GYK-29	DATA DISPLAY GROUP	1	
3	PDODD	80058	MK-1831/GYK-29	KIT,MOUNTING, COMPUT	1	
4	PDODD	80058	MK1832/GYK-29	KIT,MOUNTING,COMPUT	1	
END OF FIGURE						

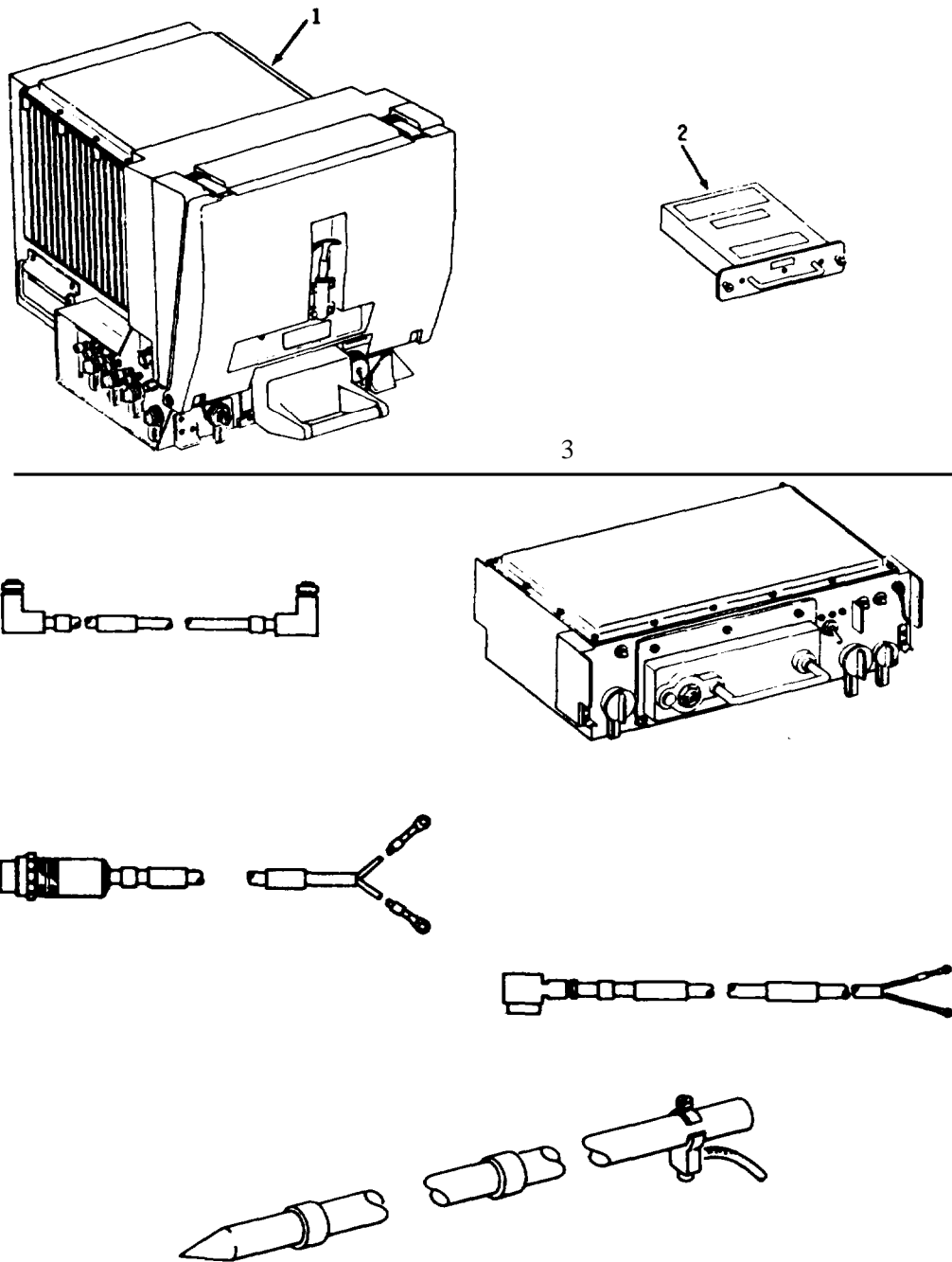

EL58E025

Figure 2. Computer Group, Gun Direction 0L-200/GYK-29(V) (Sheet 1 of 3)

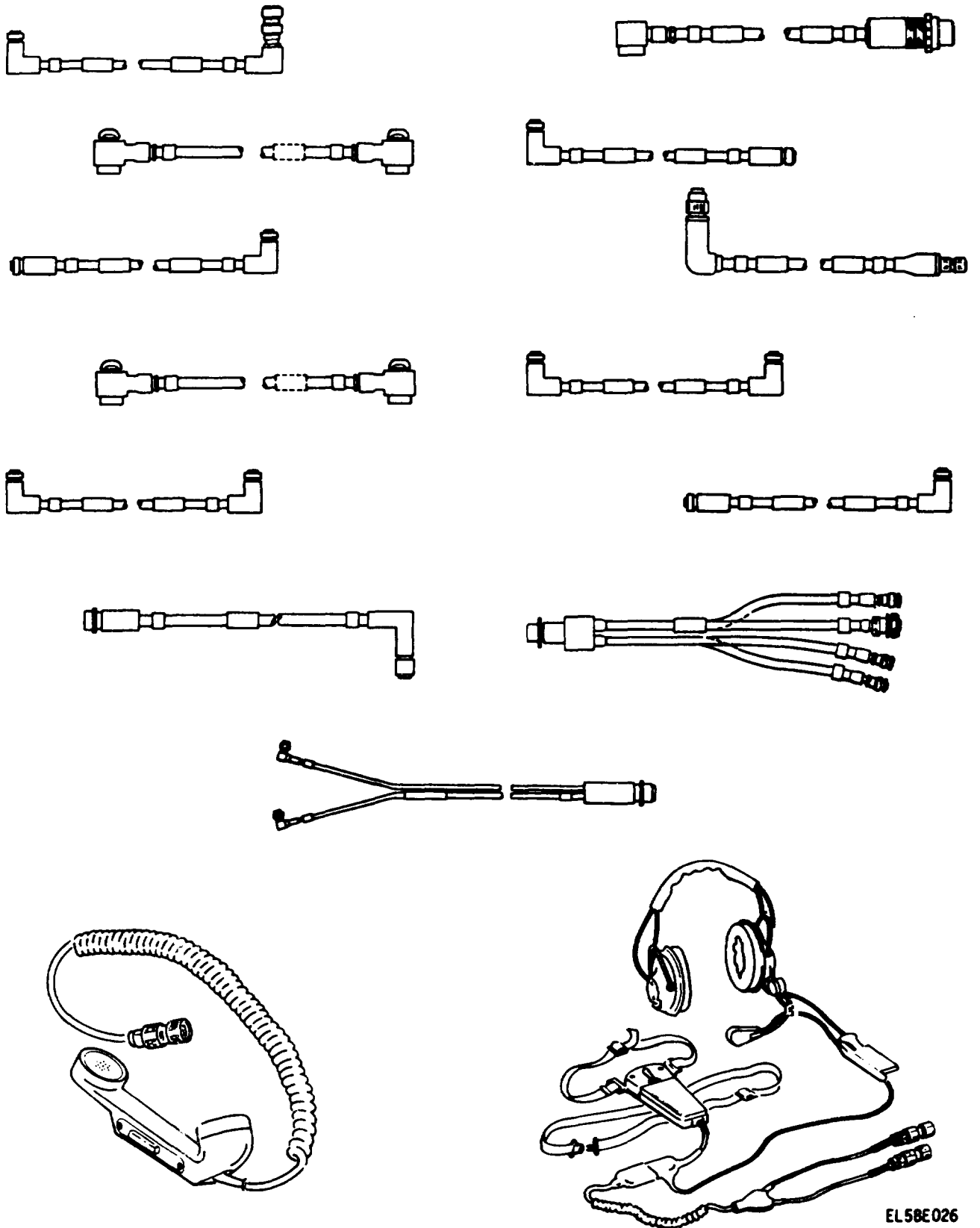

EL58E026

Figure 2. Computer Group, Gun Direction 0L-200/GYK-29(V) (Sheet 2 of 3)

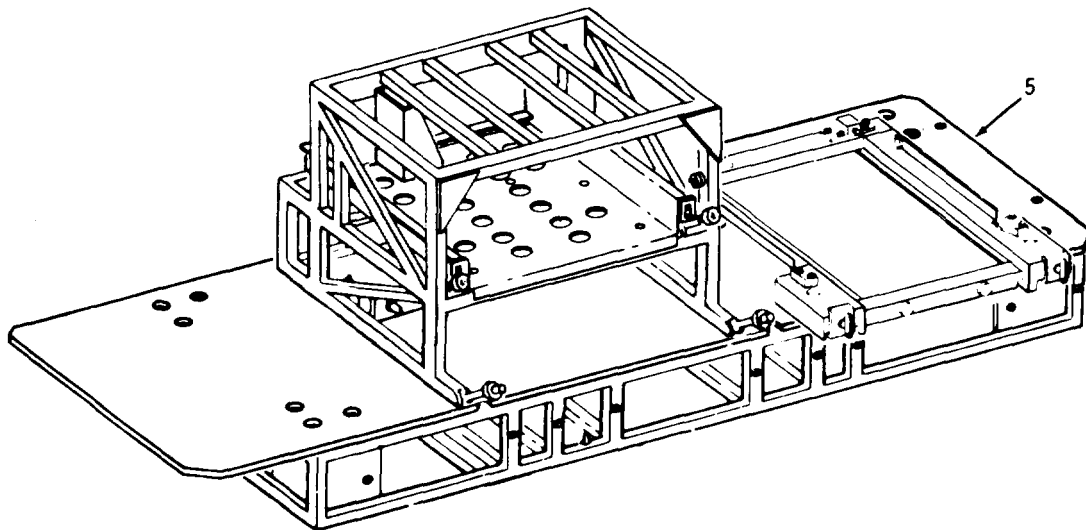

EL5BE027

Figure 2. Computer Group, Gun Direction 0L-200/GYK-29(V) (Sheet 3 of 3)

SECTION II		TM11-7440-283-20P				
(1)	(2)	(3)	(4)	(5)	(6)	
ITEM NO.	SMR CODE	FSCM	PART NUMBER	DESCRIPTION AND USABLE ON CODE (UOC)	QTY	
				GROUP 01 COMPUTER GROUP,GUN		
				DIRECTION OL-200/GYK-29(V)		
				FIGURE 2		
1	PBODD	80058	CP-1317/GYK-29	COMPUTER	1	
2	PAODD	80058	RD-439/GYK-29	TAPE,TRANSPORT UNIT	1	
3	PAODD	80058	ON-188/GYK-29	POWER DISTRIBUTION	1	
4	PAODD	80058	MK-1829/GYK-29	INTERCONNECTING KIT	1	
5	PAODD	80058	MT-4938/GYK-29	MOUNTING,BASE COMPTR	1	
				END OF FIGURE		

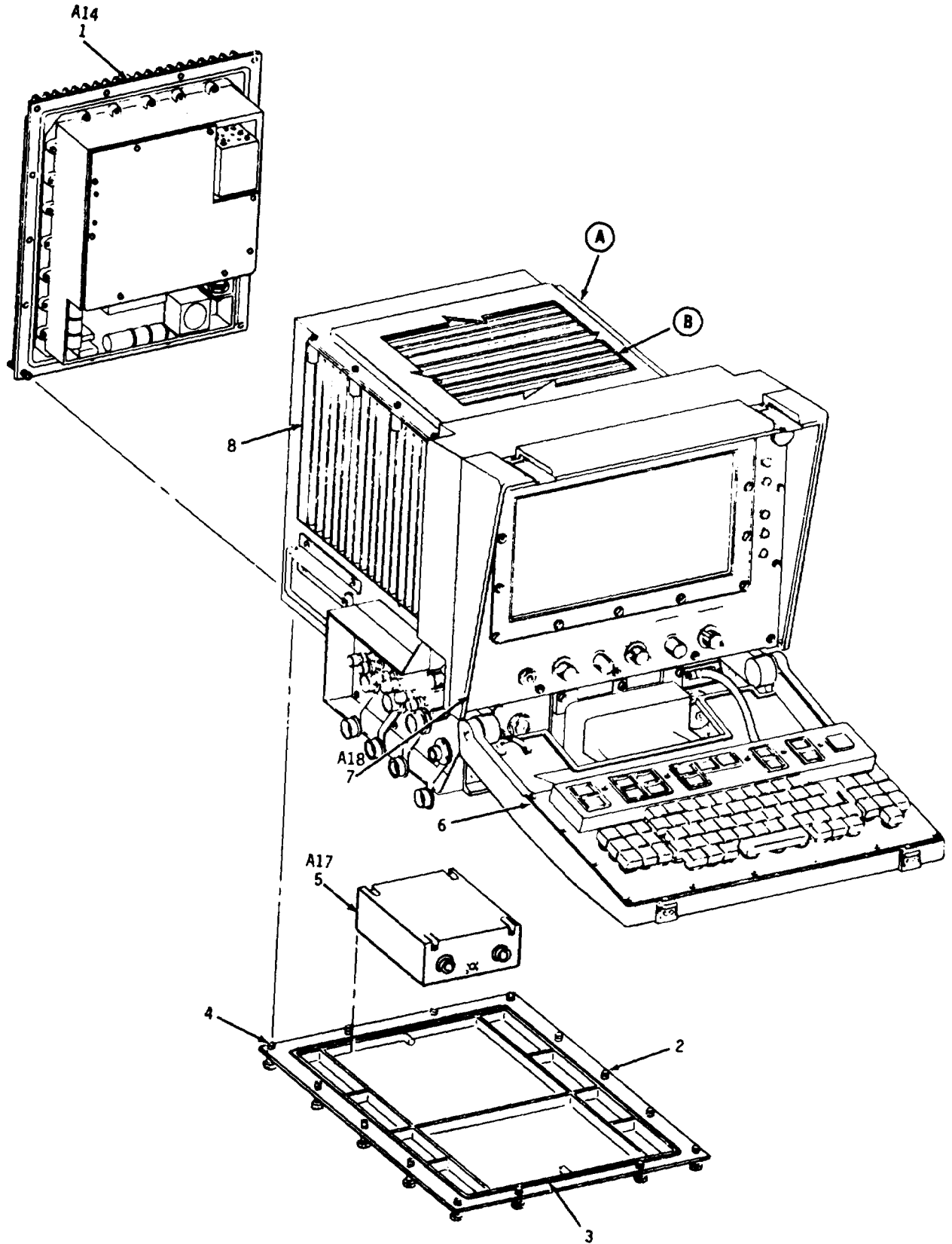
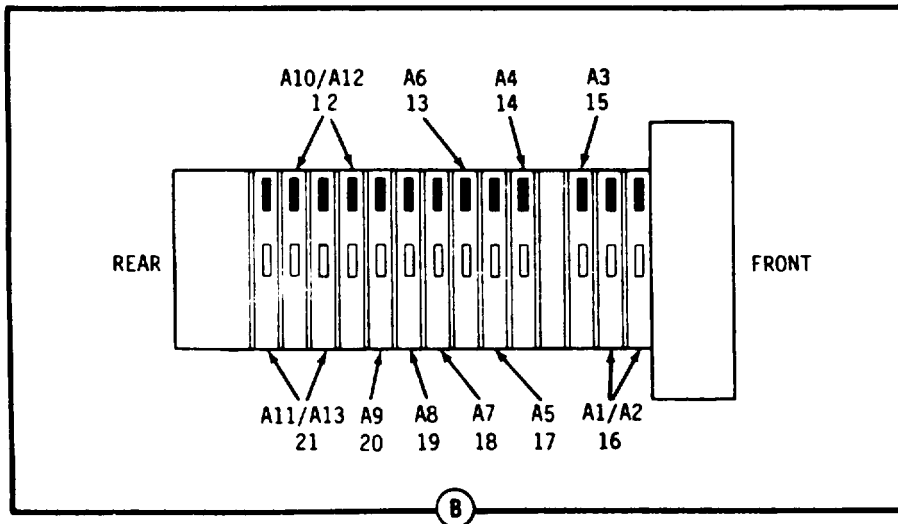
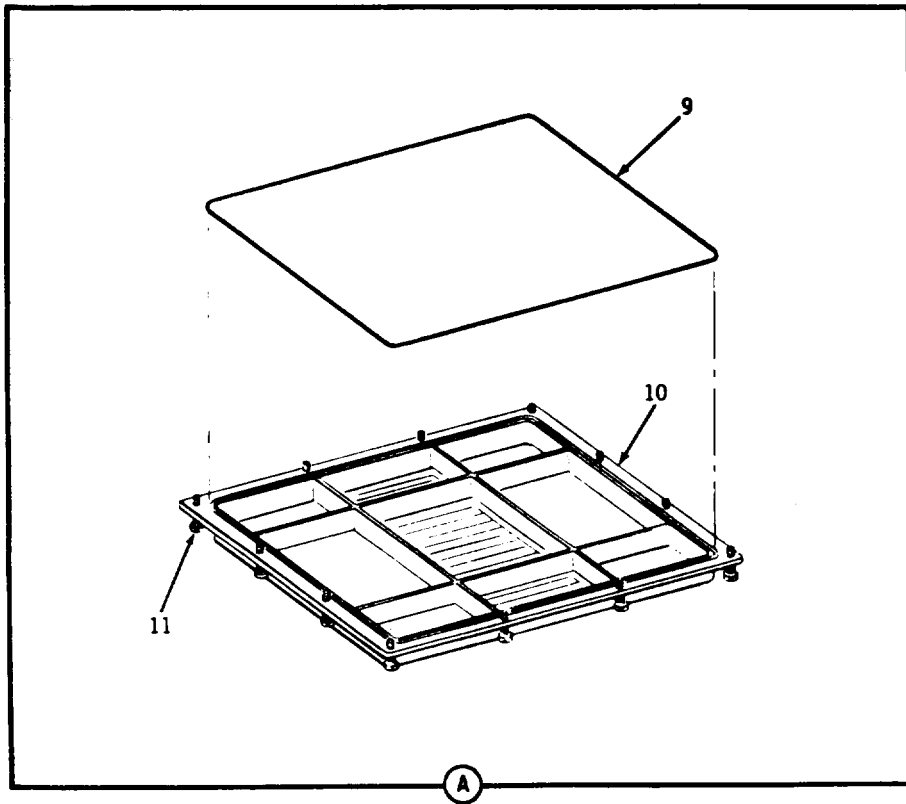

Figure 3. Computer, Gun CP-1317/GYK-29(V) (Sheet 1 of 2)

EL58E006



EL5BE007

Figure 3. Computer, Gun Direction CP-1317/GYK-29(V) (Sheet 2 of 2)

SECTION II		TM11-7440-283-20P			
(1)	(2)	(3)	(4)	(5)	(6)
ITEM	SMR		PART		
NO.	CODE	FSCM	NUMBER	DESCRIPTION AND USABLE ON CODE (UOC)	QTY
GROUP 0101 COMPUTER,GUN DIRECTION CP-1317/GYK-29(V)					
FIGURE 3					
0001	PAOLL	56996	B4009260	POWER SUPPLY ASSEMB	1
0002	XBOZZ	56996	B4009205	COVER ASSY BOTTOM	1
0004	PAOZZ	56996	B4009629-2	SCREW,MACHINE	14
0005	PAODD	56996	B4009141	TAPE ELECTRONICS U	1
0006	PAOLA	51163	15000579	KEYBOARD	1
0007	PAODD	56996	B4009270	FRONT PANEL ASSY	1
0010	XBOZZ	56996	B4009203	COVER ASSY TOP	1
0011	XBOZZ	56996	B4009629-2	SCREW CAPTIVE	12
0012	PAOLL	56996	B4009190	CIRCUIT CARD ASSY	2
0013	PAOLL	56996	B4009220	CIRCUIT CARD ASSY	1
0014	PAOLL	56996	B4009150	CIRCUIT CARD ASSY	1
0015	PAOLL	56996	B4009180	CIRCUIT CARD ASSY	1
0016	PAOLL	56996	B4009240	CIRCUIT CARD ASSY	2
0017	PAOLL	56996	B4009230	CIRCUIT CARD ASSY	1
0018	PAOLL	56996	B4009160	CIRCUIT CARD ASSY	1
0019	PAOLL	56996	B4009170	CIRCUIT CARD ASSY	1
0020	PAOLL	56996	B4009250	CIRCUIT CARD ASSY	1
0021	PAOLL	56996	B4009210	CIRCUIT CARD ASSY	2

END OF FIGURE

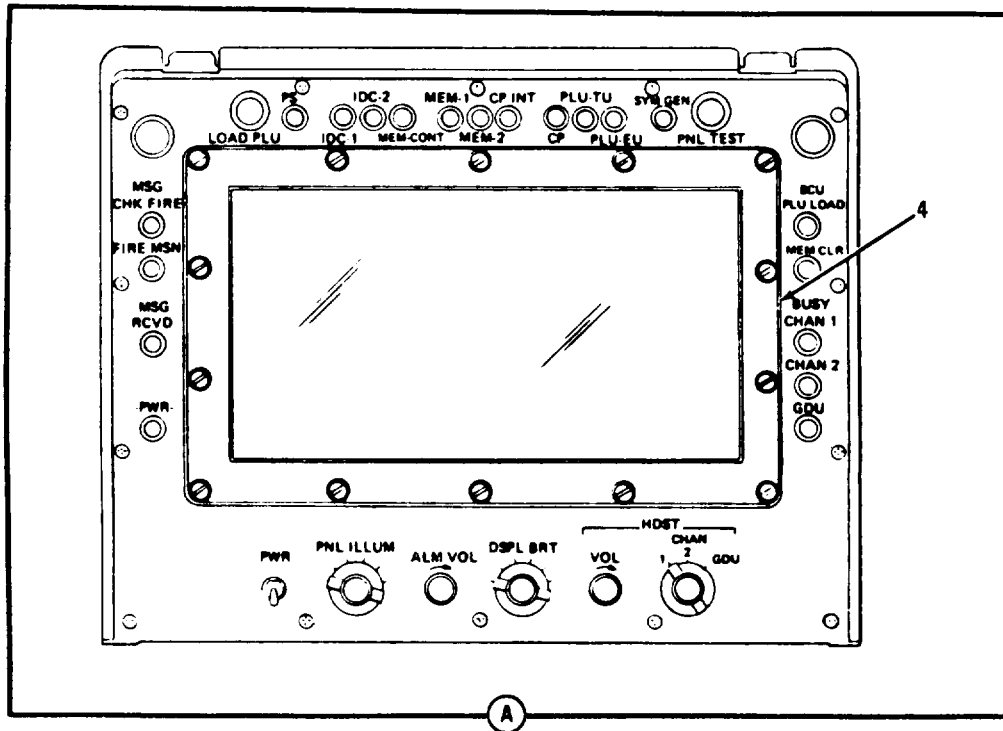
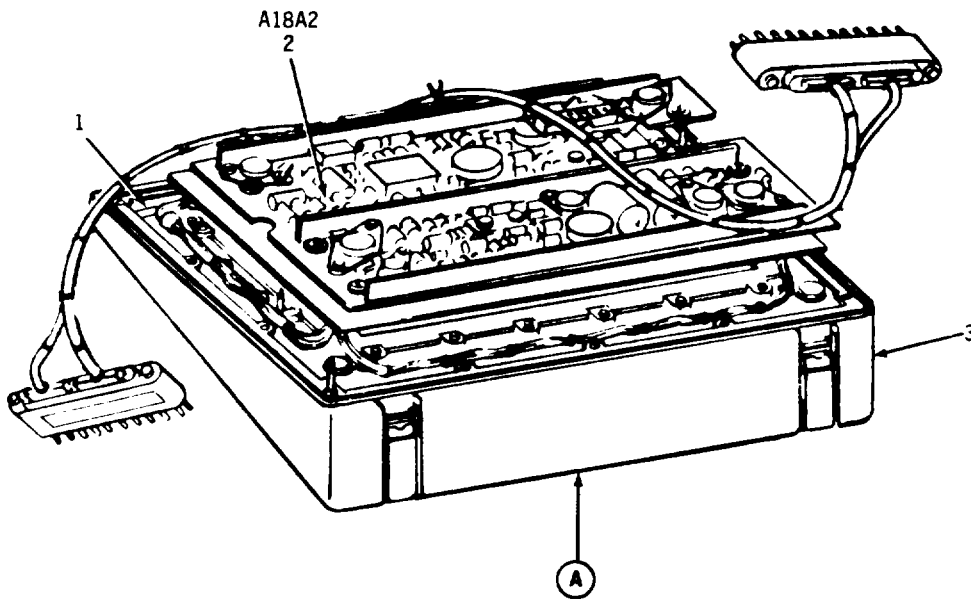

EL58E008

Figure 16. Front Panel Assembly

SECTION II		TM11-7440-283-20P			
(1)	(2)	(3)	(4)	(5)	(6)
ITEM	SMR		PART		
NO.	CODE	FSCM	NUMBER	DESCRIPTION AND USABLE ON CODE (UOC)	QTY
				GROUP 010111 FRONT PANEL ASSEMBLY	
				FIGURE 16	
0004	PAOZZ	56996	B4009704	FILTER POLARIZED A	1
				END OF FIGURE	

PREFIX ALL REFERENCE DESIGNATIONS WITH A18.

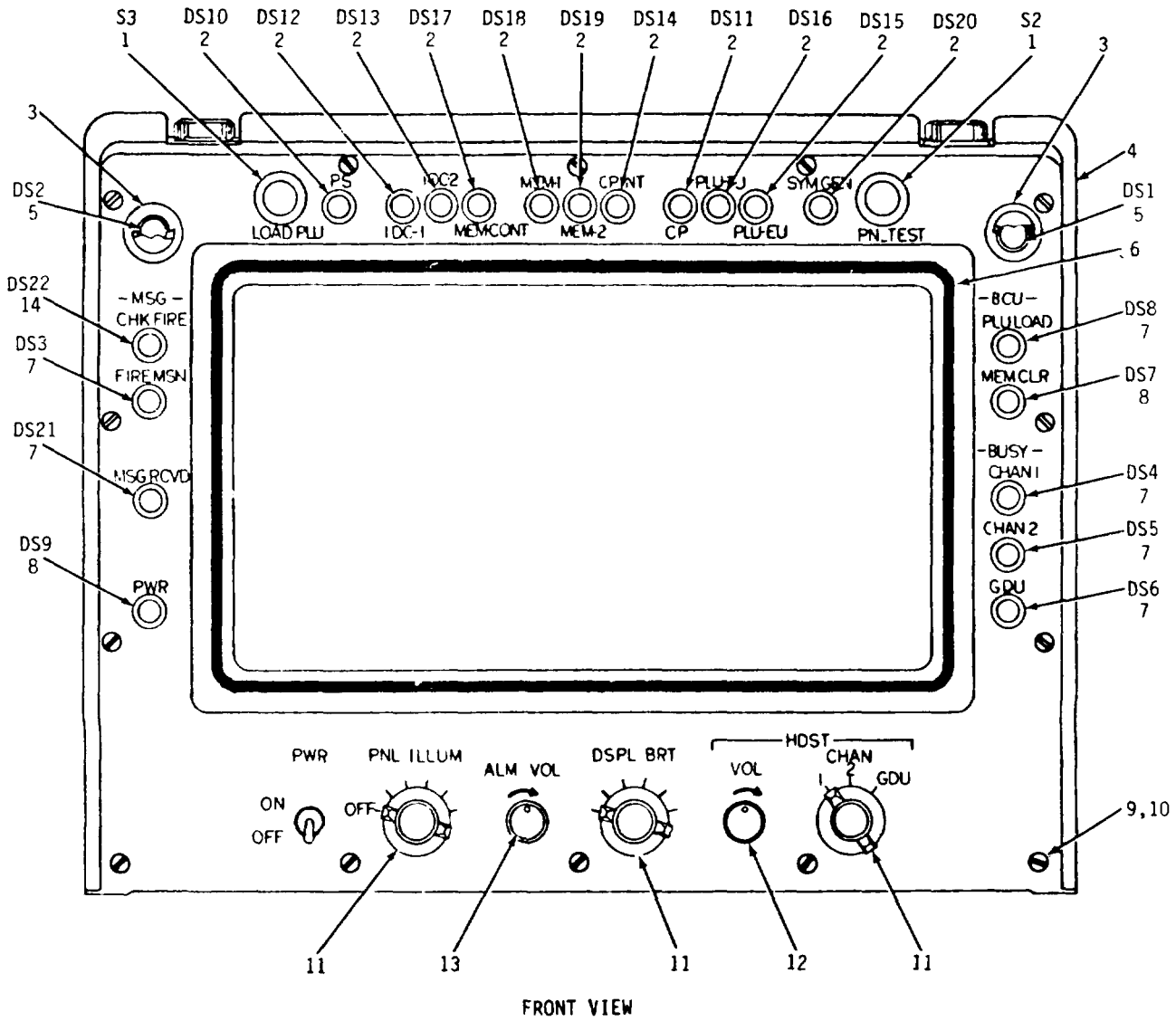

EL5BE009

Figure 23. Control Panel Assembly (Sheet 1 of 3)

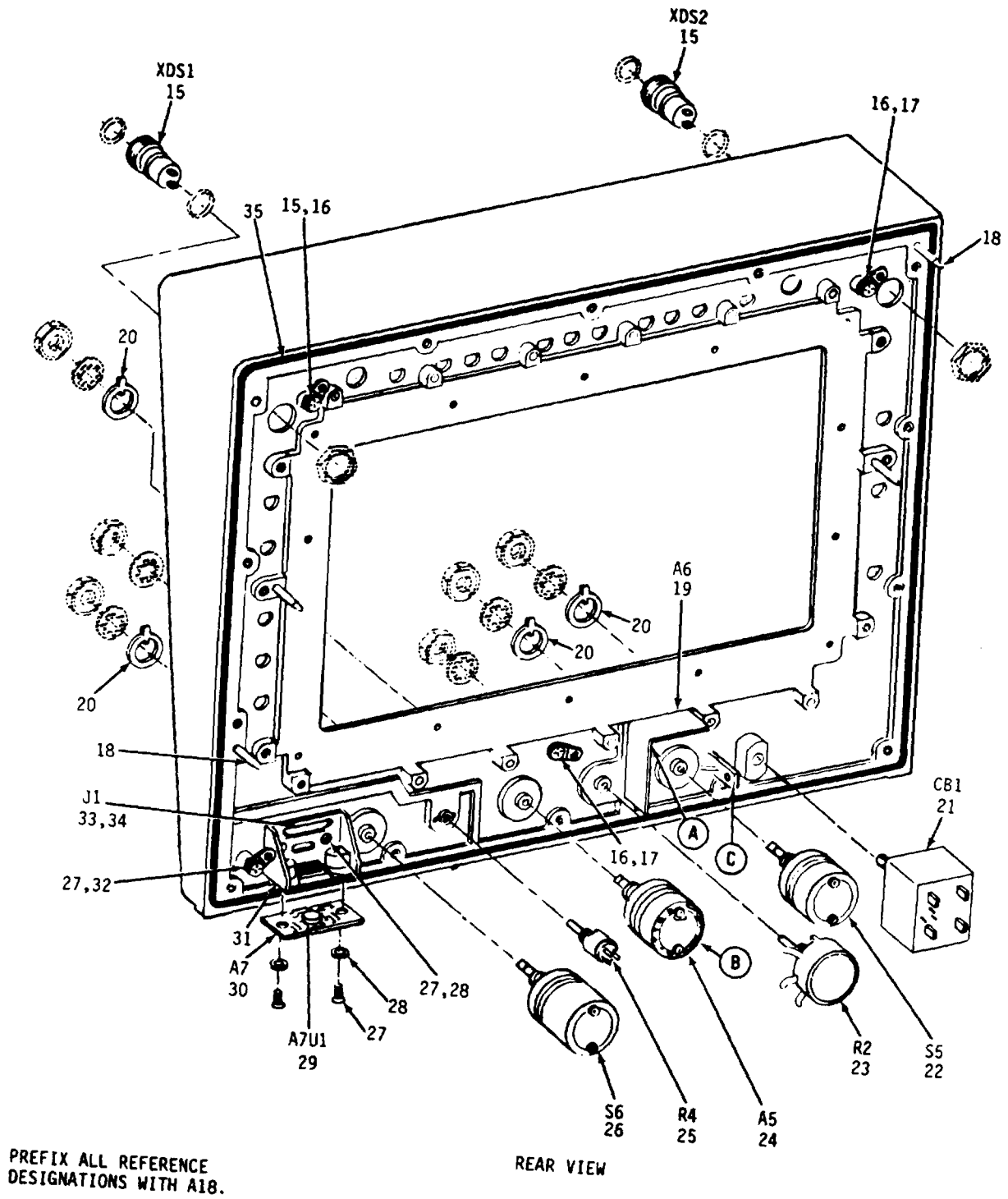

EL58E010

Figure 23. Control Panel Assembly (Sheet 2 of 3)

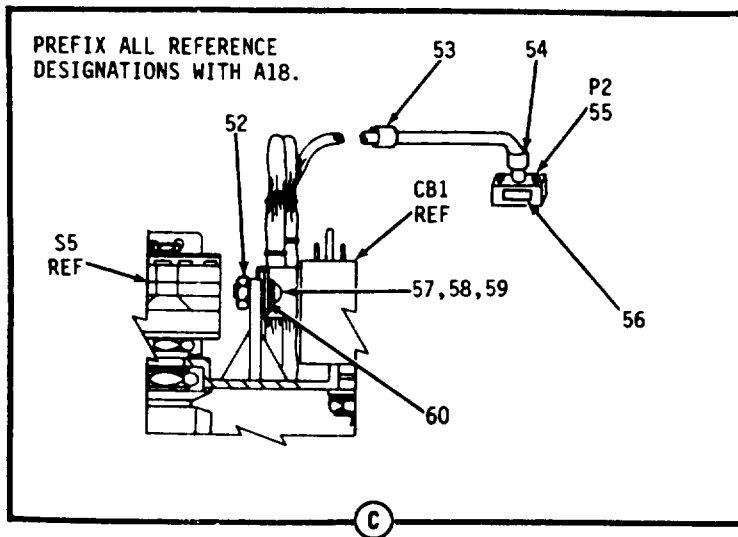
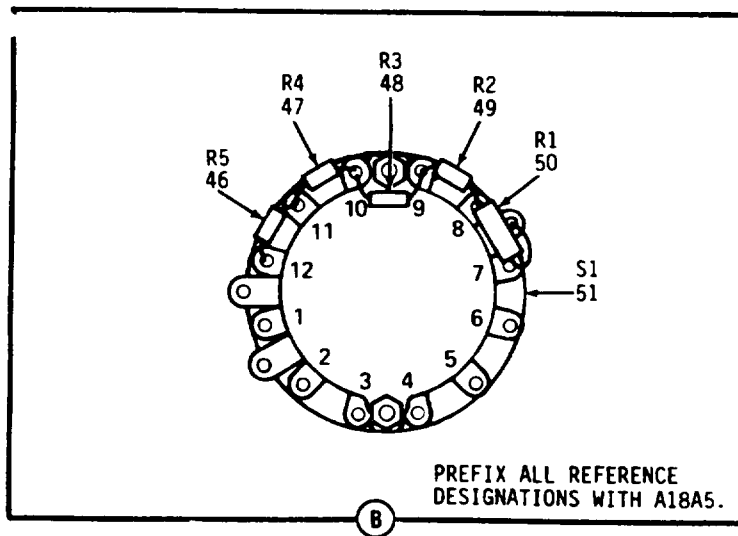
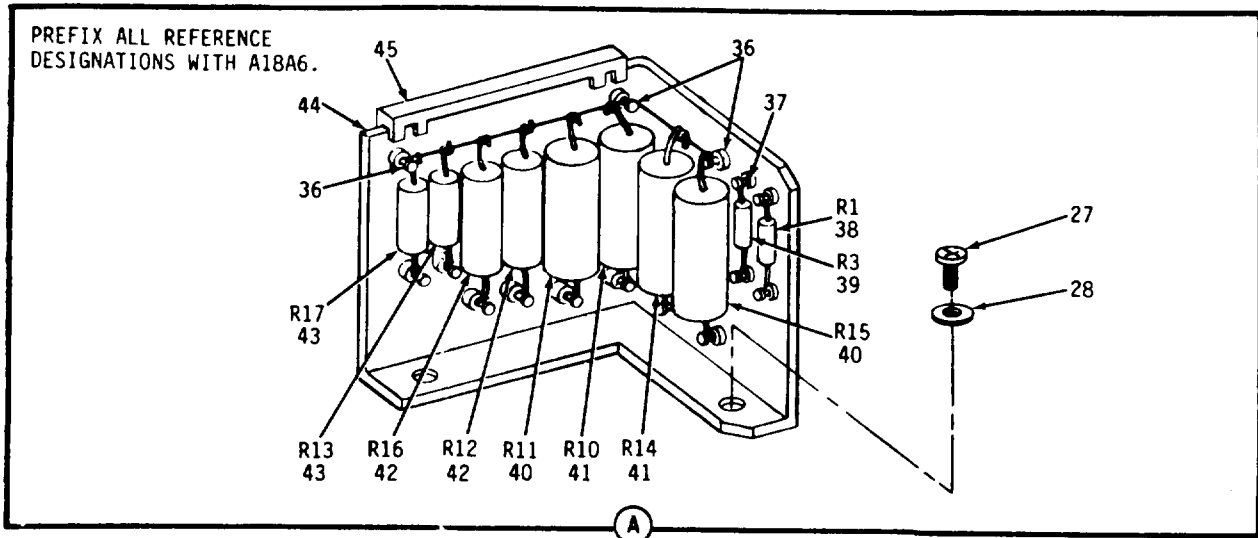

EL58E011

Figure 23. Control Panel Assembly (Sheet 3 of 3)

SECTION II		TM11-7440-283-20P			
(1)	(2)	(3)	(4)	(5)	(6)
ITEM	SMR		PART		
NO.	CODE	FSCM	NUMBER	DESCRIPTION AND USABLE ON CODE (UOC)	QTY
GROUP 01011102 CONTROL PANEL ASSEMBLY					
FIGURE 23					
0003	XBOZZ	56996	B4009762	LENS ASSY	2
0005	PAOZZ	56996	B4009424	LAMP INCANDESCENT	2
0011	PAOZZ	96906	MS91528-1114G	KNOB	3
0012	PAOZZ	96906	MS91528-1E2G	KNOB	1
0013	PAOZZ	96906	MS91528-1E1G	KNOB	1
0053	XBOZZ	56996	B4009735-2	CABLE MARKER	1
0054	XBOZZ	56996	B4009735-4	CABLE MARKER	1

END OF FIGURE

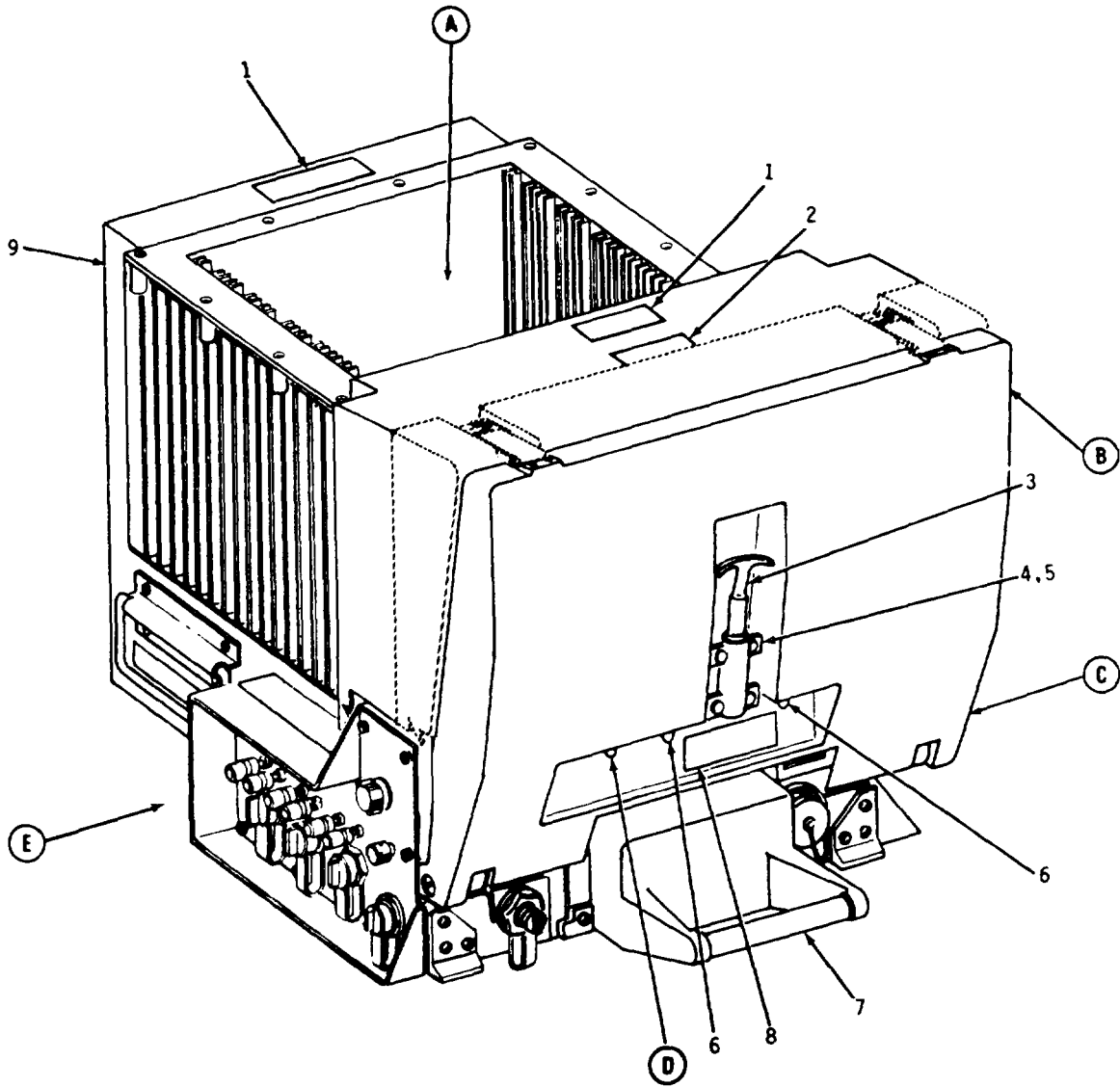

EL58E012

Figure 25. Housing Assembly (Sheet 1 of 3)

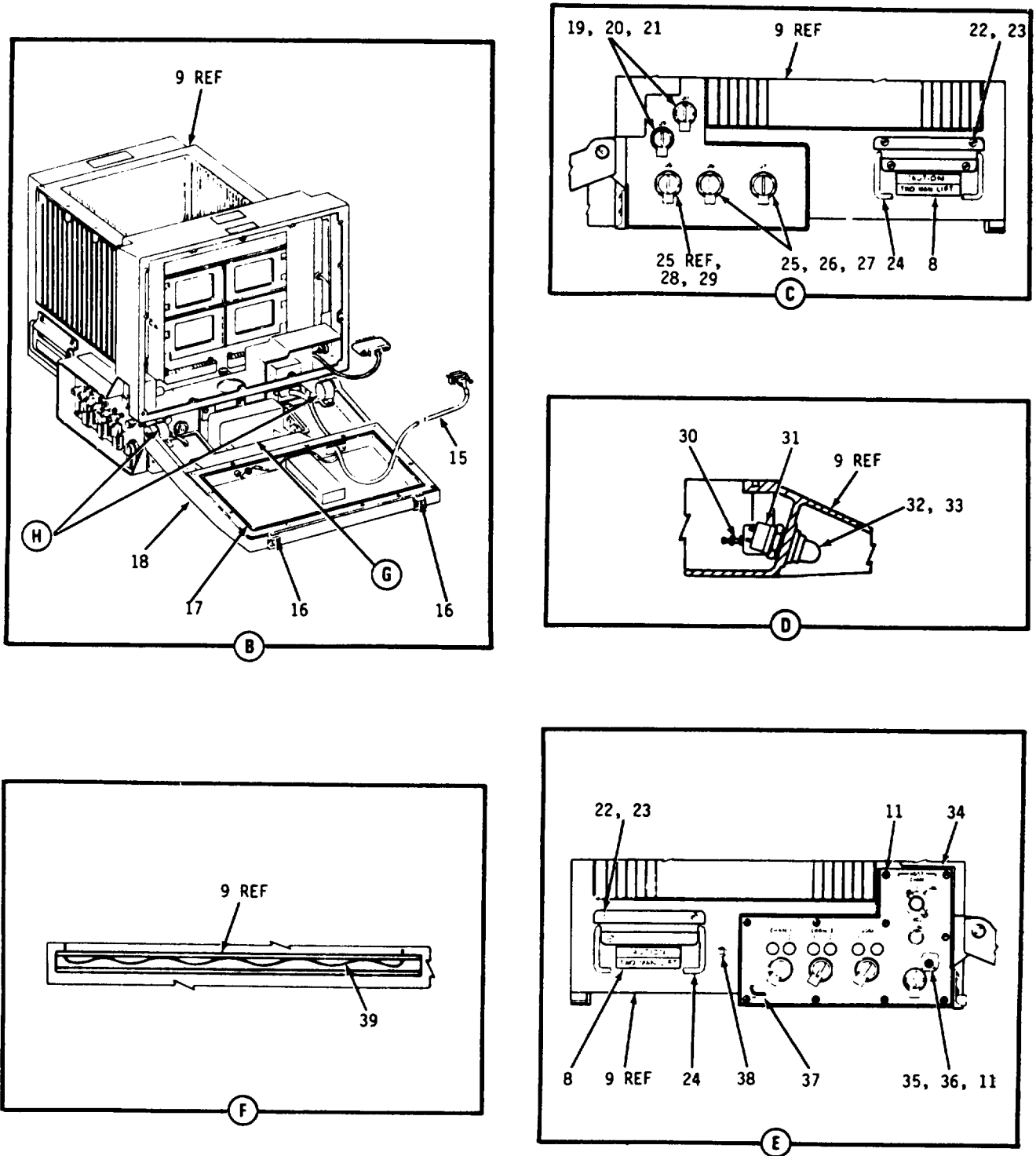

EL58E013

Figure 25. Housing Assembly (Sheet 2 of 3)

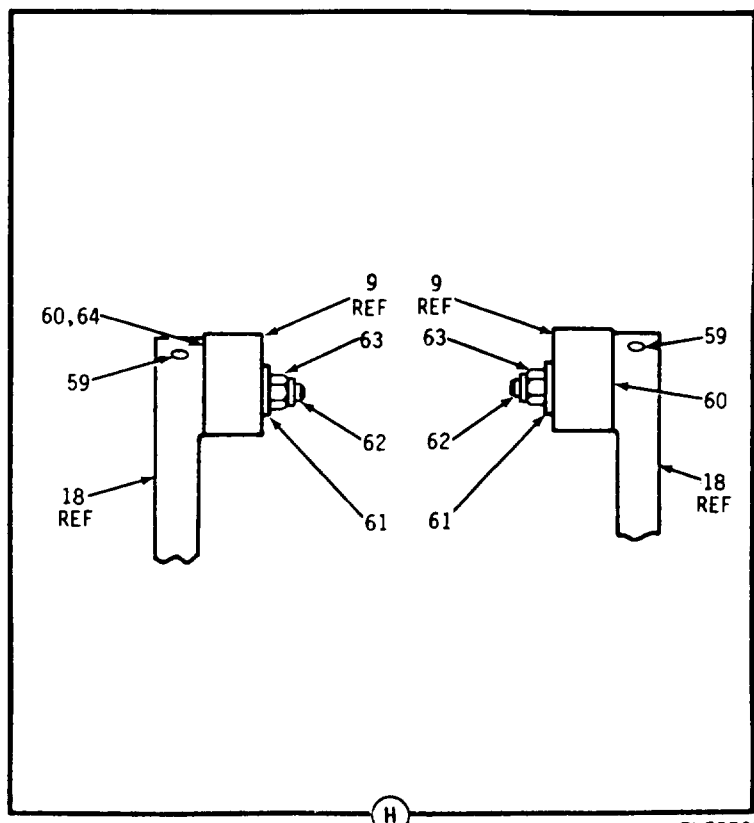
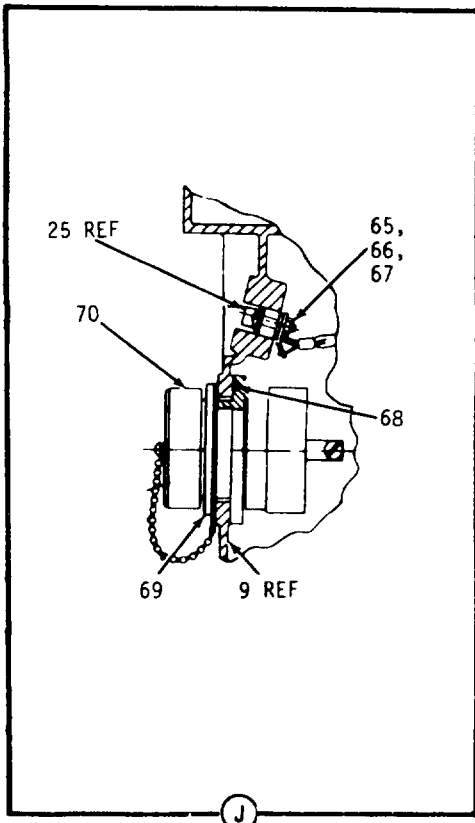
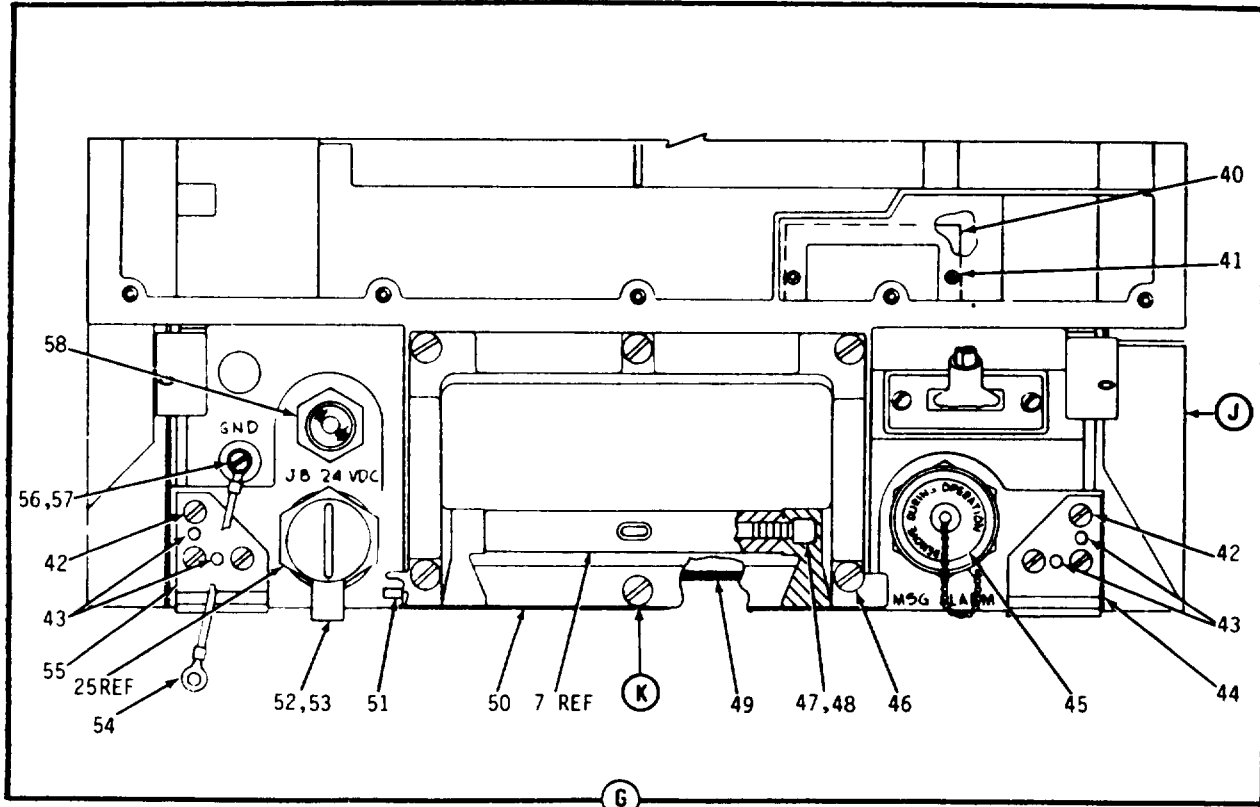

EL5BE014

Figure 25. Housing Assembly (Sheet 3 of 3)

SECTION II		TM11-7440-283-20P			
(1)	(2)	(3)	(4)	(5)	(6)
ITEM	SMR		PART		
NO.	CODE	FSCM	NUMBER	DESCRIPTION AND USABLE ON CODE (UOC)	QTY
GROUP 010115 HOUSING ASSEMBLY					
FIGURE 25					
0004	XBOZZ	70318	400B0816	SCREW HEX HD	4
0005	PAOZZ	96906	MS15795-807	WASHER FLAT	4
0032	PAOZZ	56996	64009606-2	LAMPHOLDER	1
0033	PAOZZ	81348	WL111TRADEN0330	LAMP, INCANDESCENT	1
0046	XBOZZ	56996	B4009629-2	SCREW CAPTIVE	6
0054	PAOZZ	96906	MS25083-3PB8	LEAD, ELECTRICAL	1
0056	PAOZZ	96906	MS51957-61	SCREW, MACHINE	1
0057	PAOZZ	06424	0770-9	WASHER, FLAT	1

END OF FIGURE

PREFIX ALL REFERENCE DESIGNATIONS WITH A16.

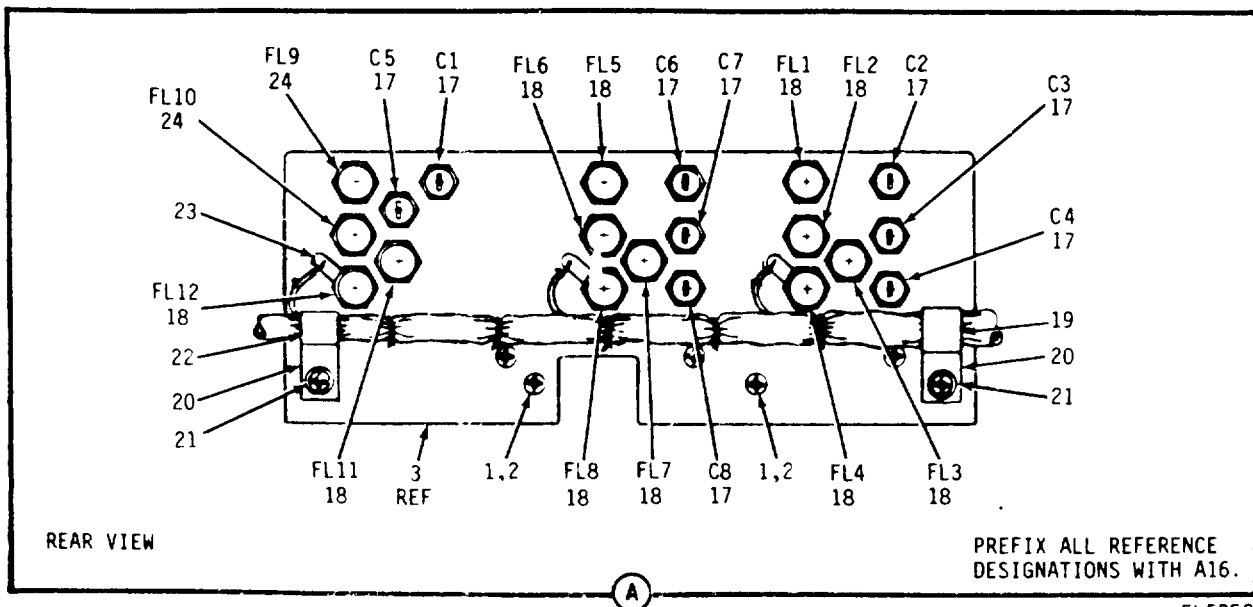
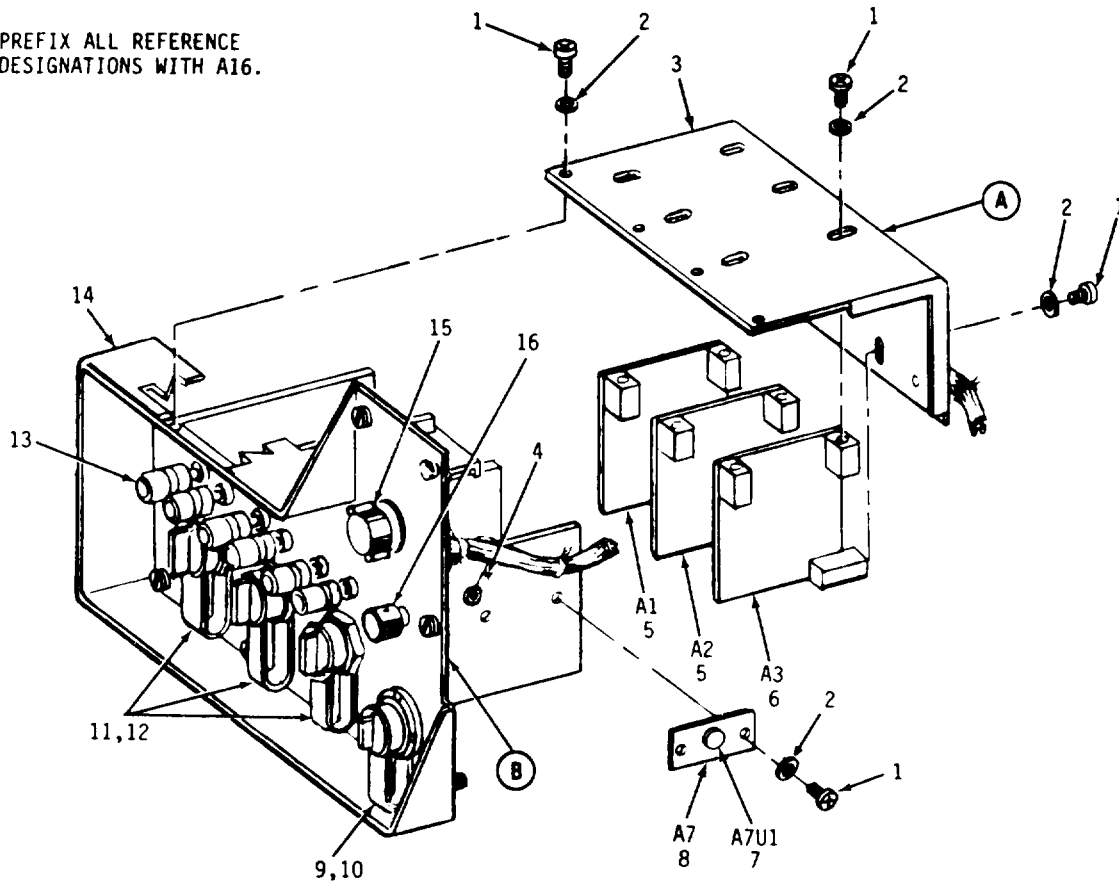
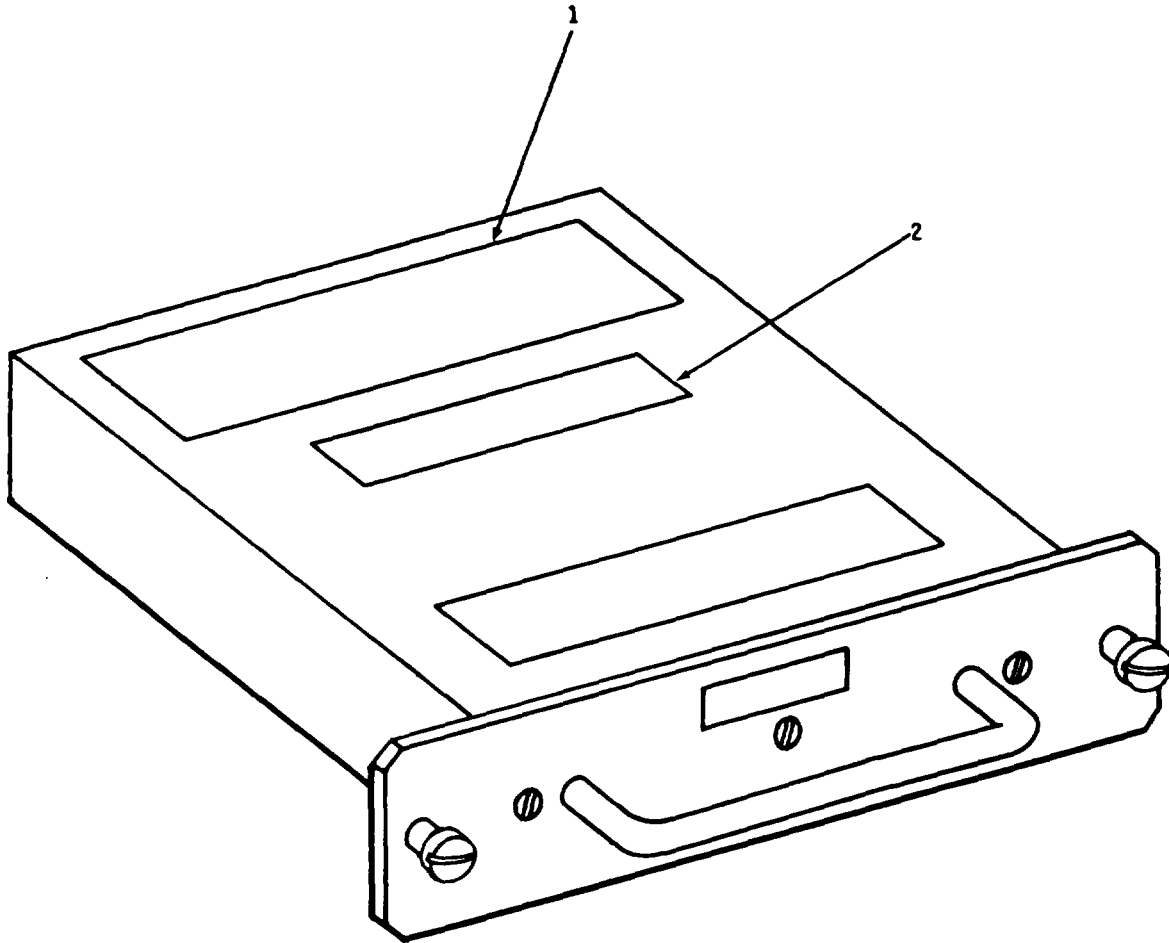

Figure 27. Comm Channel Filter Assembly

EL5BE015

SECTION II		TM11-7440-283-20P			
(1)	(2)	(3)	(4)	(5)	(6)
ITEM	SMR		PART		
NO.	CODE	FSCM	NUMBER	DESCRIPTION AND USABLE ON CODE (UOC)	QTY
				GROUP 01011502 COMM CHANNEL FILTER ASSEMBLY	
				FIGURE 27	
0015	PAOZZ	96906	MS91528-1112G	KNOB	1
0016	PAOZZ	96906	MS91528-1EIG	KNOB	1
				END OF FIGURE	



EL58E021

Figure 28. Tape Transport Unit RD-439/GYK-29(V)

SECTION II		TM11-7440-283-20P			
(1)	(2)	(3)	(4)	(5)	(6)
ITEM	SMR		PART		
NO.	CODE	FSCM	NUMBER	DESCRIPTION AND USABLE ON CODE (UOC)	QTY
				GROUP 0102 TAPE TRANSPORT UNIT	
				RD-439/GYK-29(V)	
				FIGURE 28	
0001	XBOZZ	56696	B4009947	PLATE IDENT	1
0002	XBOZZ	56696	B4009979	DECAL	1
				END OF FIGURE	

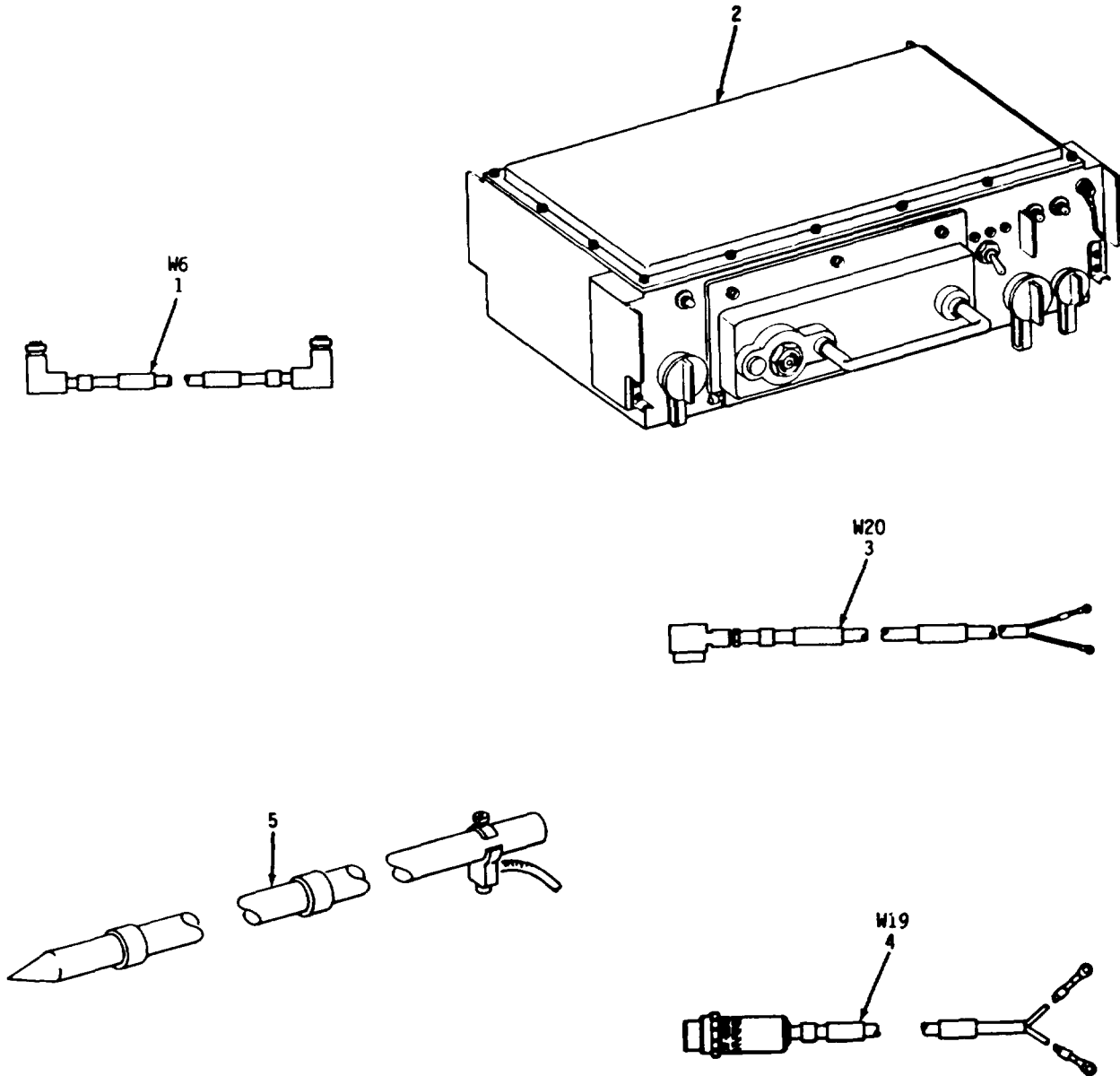

EL5BE022

Figure 29. Power Distribution Group ON-188 /GyK-29(v)

SECTION II				TM11-7440-283-20P	
(1)	(2)	(3)	(4)	(5)	(6)
ITEM NO.	SMR CODE	FSCM	PART NUMBER	DESCRIPTION AND USABLE ON CODE (UOC)	QTY
GROUP 0103 POWER DISTRIBUTION GROUP					
FIGURE 29					
0002	PAODD	56996	B4009290	POWER DISTRIBUTION	1
0005	XBOZZ	81349	5975-X07-8007	GROUND STAKE KIT	1
END OF FIGURE					

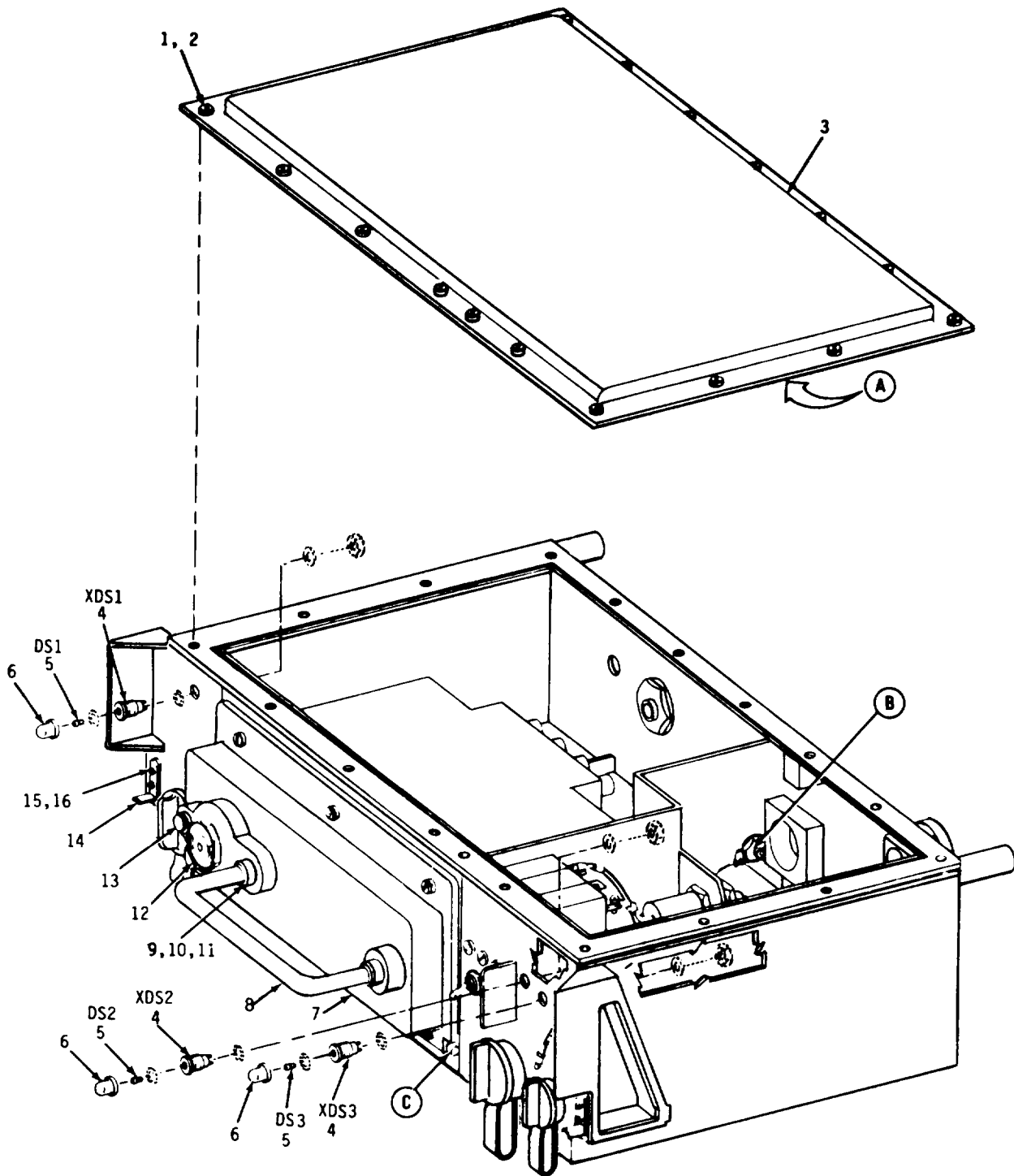

EL58E023

Figure 30. Power Distribution Unit

SECTION II		TM11-7440-283-20P				
(1)	(2)	(3)	(4)	(5)	(6)	
ITEM NO.	SMR CODE	FSCM	PART NUMBER	DESCRIPTION AND USABLE ON CODE (UOC)	QTY	
GROUP 010301 POWER DISTRIBUTION UNIT						
FIGURE 30						
0005	PAOZZ	81348	W-L-00111/7	LAMP, INCANDESCENT	3	
0006	PAOZZ	76854	7-P50	LENS, LIGHT	3	
END OF FIGURE						

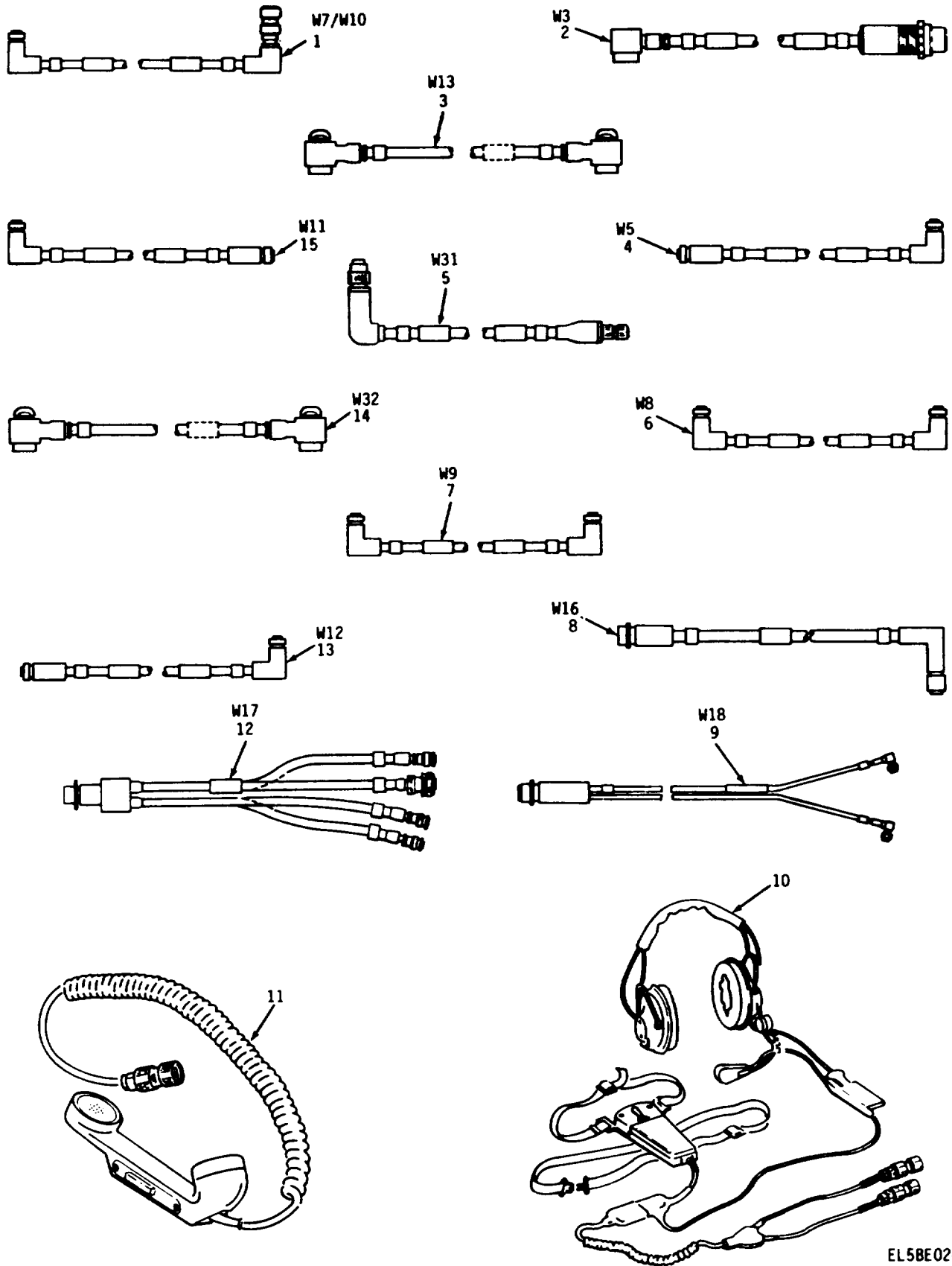

EL5BE024

Figure 31. Interconnecting Kit MK-1829/GYK-29(V)

SECTION II		TM11-7440-283-20P				
(1)	(2)	(3)	(4)	(5)	(6)	
ITEM	SMR		PART			
NO.	CODE	FSCM	NUMBER	DESCRIPTION AND USABLE ON CODE (UOC)		QTY
				GROUP 0104 INTERCONNECTING KIT MK-1829/GYK-29(V)		
				FIGURE 31		
0010	PAOZZ	81349	H-161D/U	HEADSET-MICROPHONE		1
0011	PAOZZ	80058	H-189/GR	HANDSET		1
				END OF FIGURE		

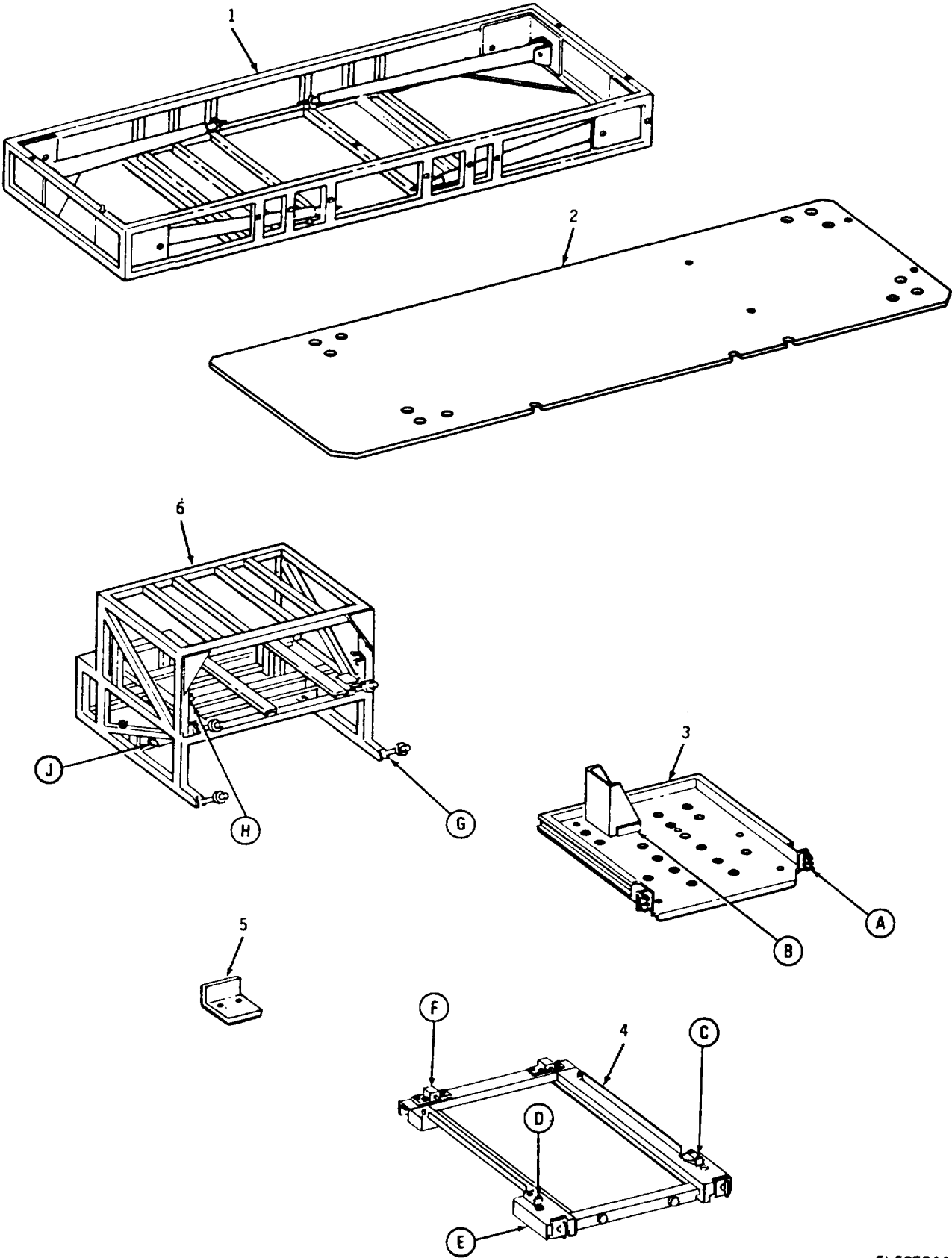

Figure 32. Mounting Base, Computer Gun Direction MT-4938/GYK-29(V)
(Sheet 1 of 2)

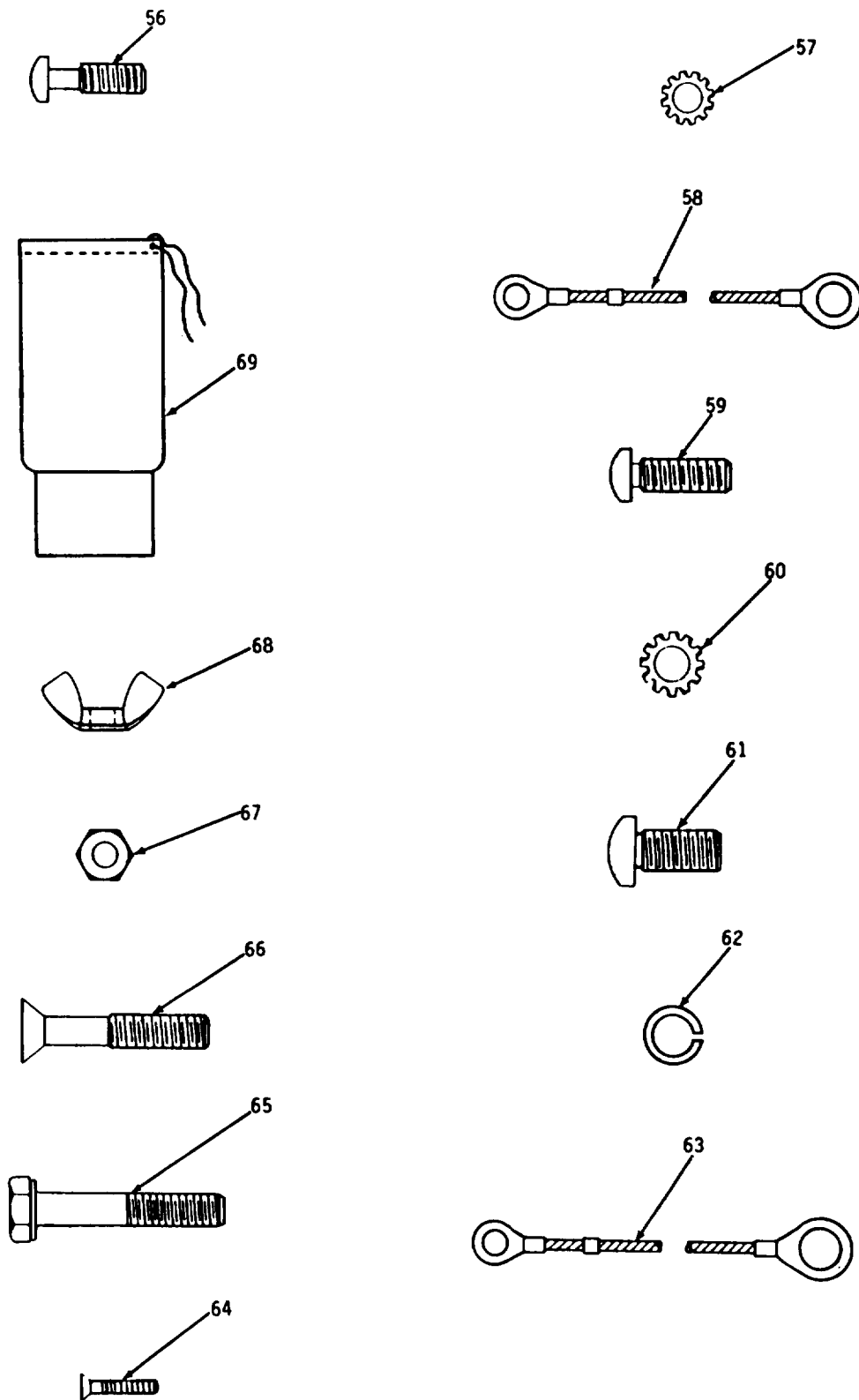
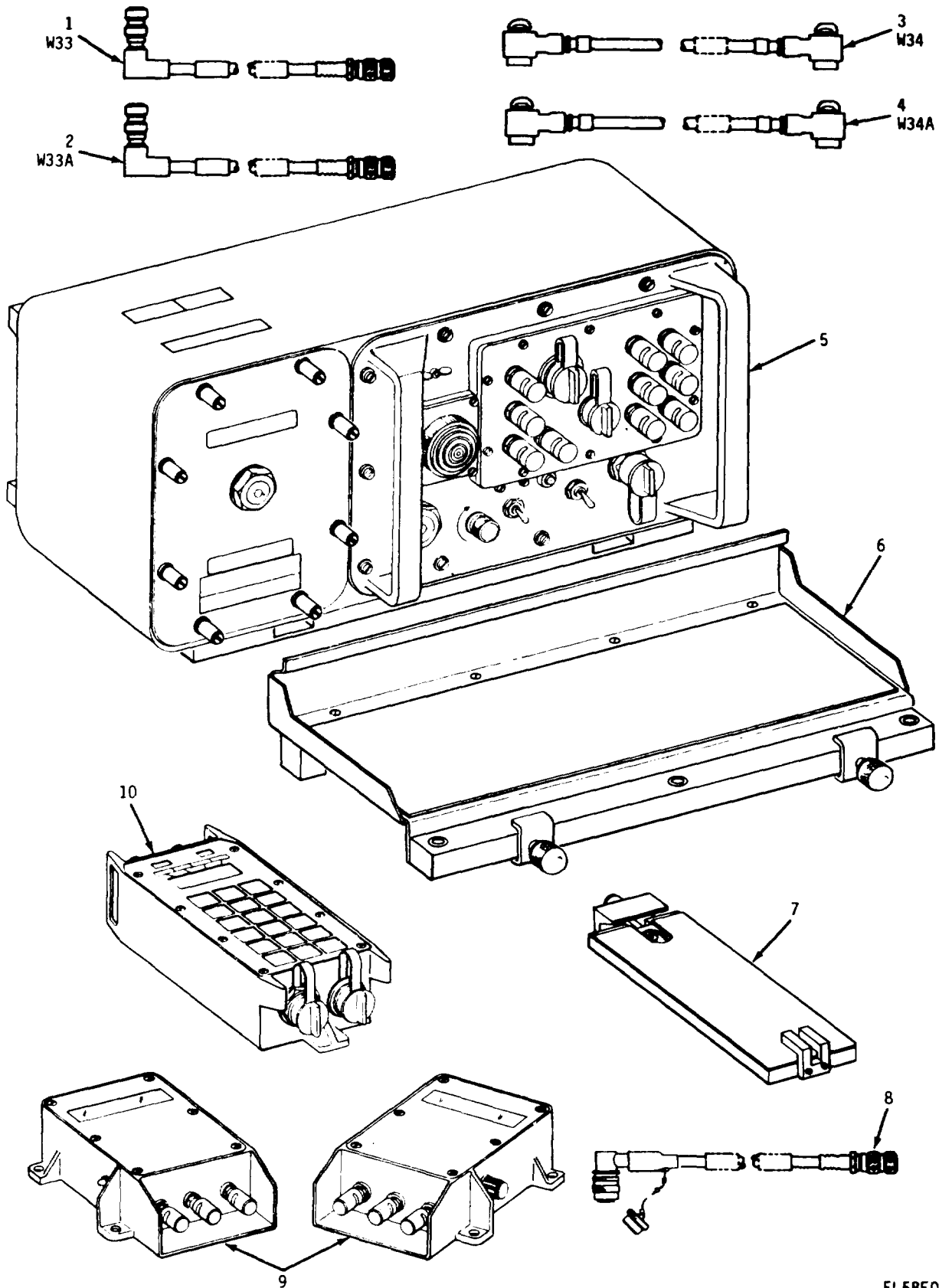

Figure 32. Mounting Base, Computer Gun Direction MT-4938/GYK-29(v)
(shoot 2 of 2)

EL58F048

SECTION II		TM11-7440-283-20P				
(1)	(2)	(3)	(4)	(5)	(6)	
ITEM NO.	SMR CODE	FSCM	PART NUMBER	DESCRIPTION AND USABLE ON CODE (UOC)	QTY	
				GROUP 0105 MOUNTING BASE, COMPUTER GUN DIRECTION MT-4938/GYK-29(V)		
				FIGURE 32		
0003	XBOFF	56996	B4009723	TRAY MTG ASSY	1	
0004	XBOFF	56996	B4009721	TRAY MTG ASSY	1	
0069	PAOZZ	80063	SC-B-49729-7	BAG,MAILING	3	
				END OF FIGURE		



EL58E017

Figure 33. Data Display Group, Gun Direction OD-144(V)/GYK-ZXJ(V)

SECTION II		TM11-7440-283-20P				
(1)	(2)	(3)	(4)	(5)	(6)	
ITEM NO.	SMR CODE	FSCM	PART NUMBER	DESCRIPTION AND USABLE ON CODE (UOC)		QTY
GROUP 02 DATA DISPLAY GROUP, GUN DIRECTION OD-144(V)/GYK-29(V)						
FIGURE 33						
1	PAODD	56996	B4009399-1	CABLE ASSEMBLY, SPEC UOC:EL4, FH5		1
2	PAODD	56996	B4009399-2	CABLE ASSEMBLY, SPEC UOC:FH4		1
3	PAODD	56996	B4009398-2	CABLE ASSEMBLY, POW UOC:EL4, FH5		1
4	PAODD	56996	B4009398-3	CABLE ASSEMBLY, POW UOC:FH4		1
5	PAODD	56996	B401000I	CONTROL CASE, DATA		1
6	PFOZZ	56996	B4010043	INSTL KIT GDU UOC:EL4, FH4		1
7	PFOZZ	56996	B4010048	SCA INSTL KIT UOC:FH4		1
8	PAODD	56996	B4010085	CABLE ASSEMBLY, POW		
9	PAOLL	56996	B4010039	DATA DISPLAY DEFLE		1
10	PAOLL	56996	B4010002	DATA DISPLAY GROUP		1
END OF FIGURE						

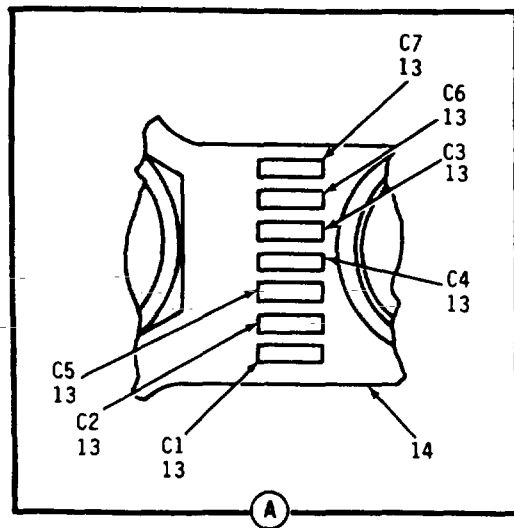
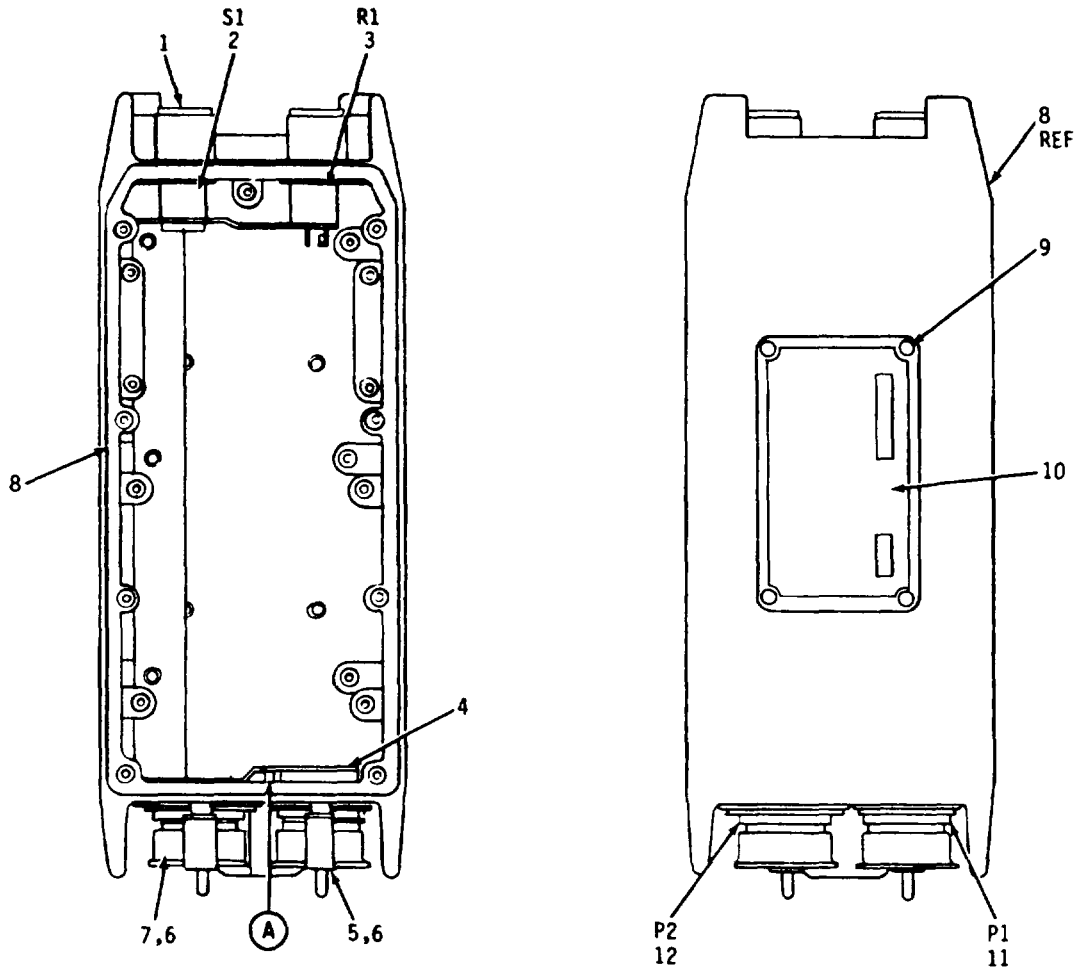

EL5BE018

Figure 37. Housing Assembly, SCA

SECTION II		TM11-7440-283-20P			
(1)	(2)	(3)	(4)	(5)	(6)
ITEM NO.	SMR CODE	FSCM	PART NUMBER	DESCRIPTION AND USABLE ON CODE (UOC)	QTY
				GROUP 020103 HOUSING ASSEMBLY, SCA	
				FIGURE 37	
1	PAOZZ	96906	MS91528-1N1B	KNOB	2
				END OF FIGURE	

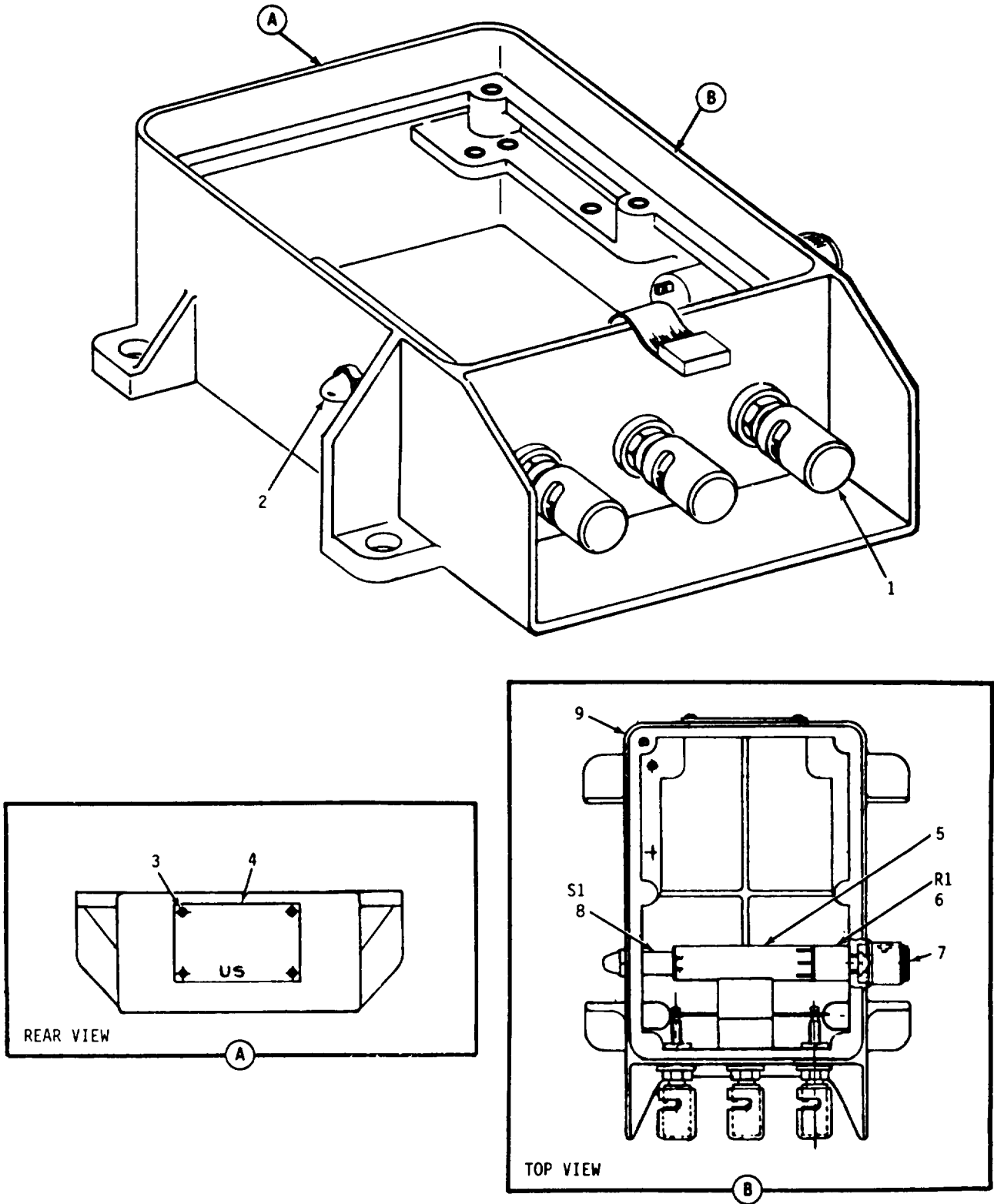

EL5BE019

Figure 40. Housing Assembly, GA

SECTION II		TM11-7440-283-20P			
(1)	(2)	(3)	(4)	(5)	(6)
ITEM	SMR		PART		
NO.	CODE	FSCM	NUMBER	DESCRIPTION AND USABLE ON CODE (UOC)	QTY
				GROUP 020202 HOUSING ASSEMBLY, GA	
				FIGURE 40	
7	PAOZZ	96906	MS91528-1NIB	KNOB	1
				END OF FIGURE	

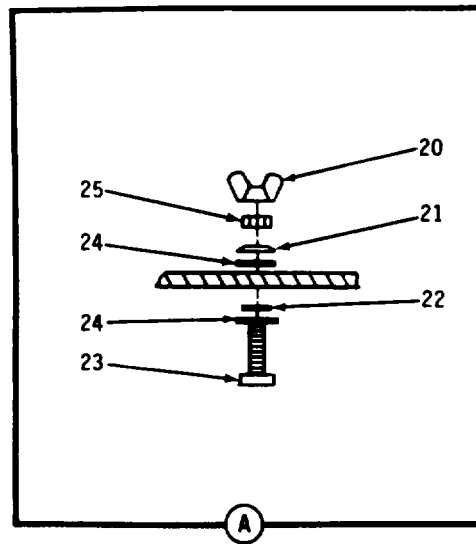
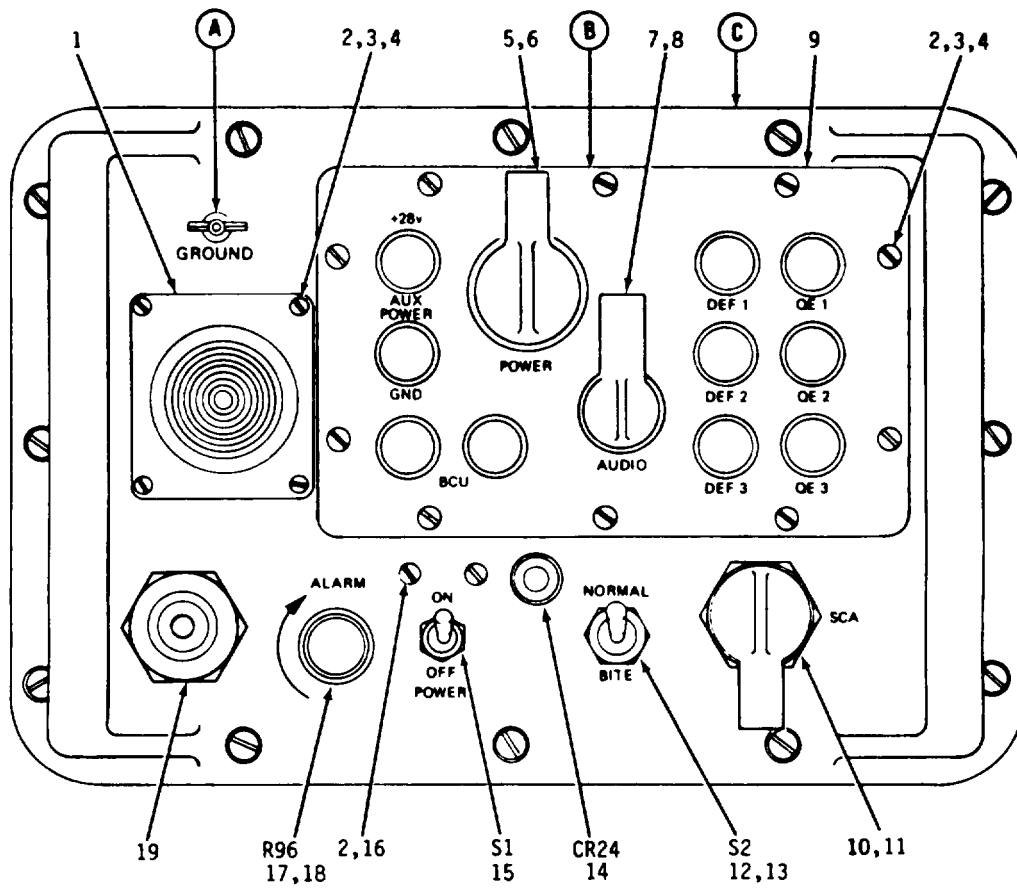
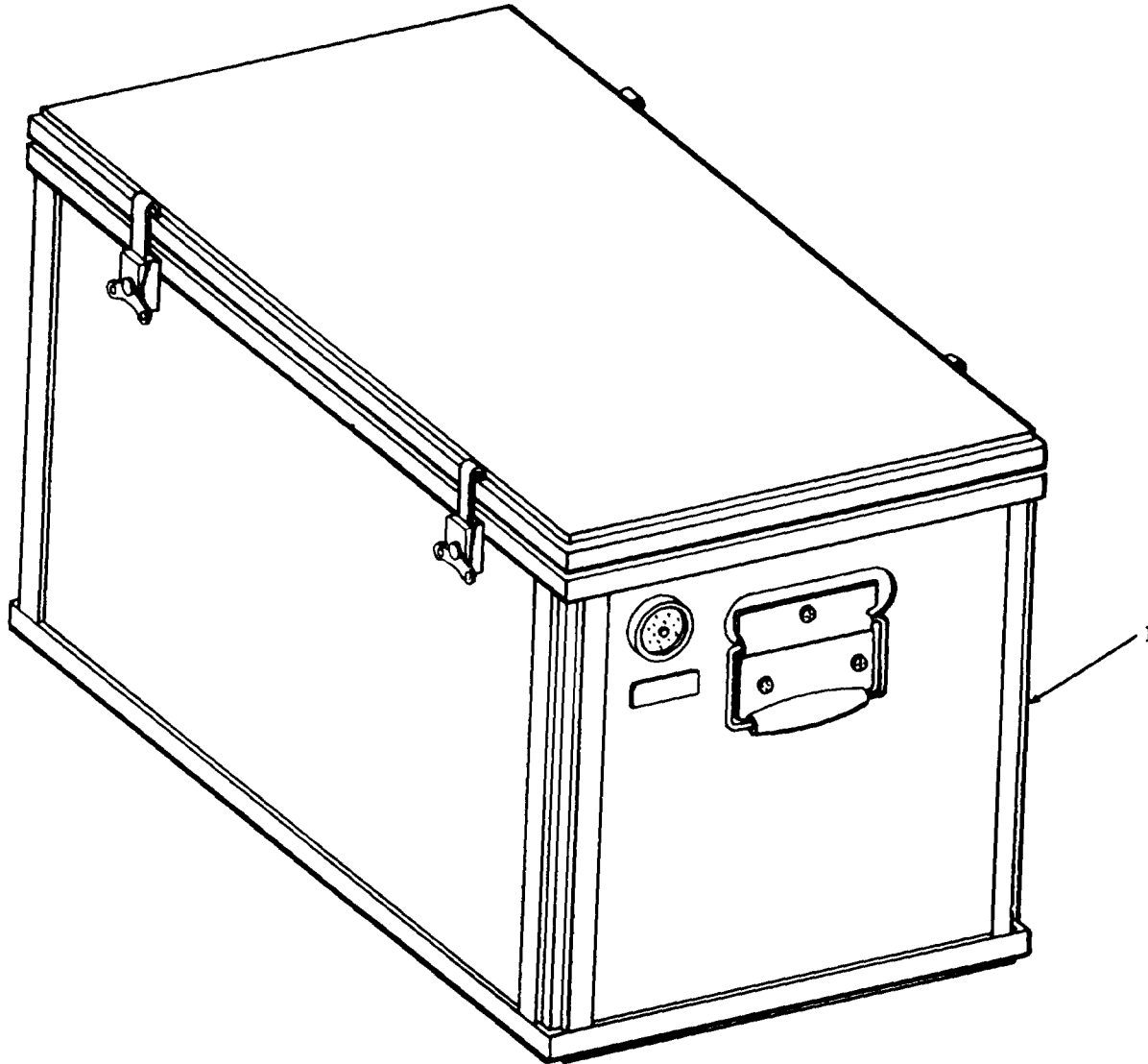

Figure 44. Power Supply Unit Chassis Assembly

SECTION II		TM11-7440-283-20P				
(1)	(2)	(3)	(4)	(5)	(6)	
ITEM NO.	SMR CODE	FSCM	PART NUMBER	DESCRIPTION AND USABLE ON CODE (UOC)	QTY	
				GROUP 02030101 POWER SUPPLY UNIT CHASSIS ASSEMBLY		
				FIGURE 44		
18	PAOZZ	96906	MS91528-1N1B	KNOB	1	
				END OF FIGURE		



EL58E030

Figure 50. Special Tools

SECTION III			TM11-7440-283-20P		
(1)	(2)	(3)	(4)	(5)	(6)
ITEM	SMR		PART		
NO.	CODE	FSCM	NUMBER	DESCRIPTION AND USABLE ON CODE (UOC)	QTY
				GROUP 30 SPECIAL TOOLS	
				FIGURE 50	
0001	PAOZZ	56996	B4030165	CARD CARRY CASE (BOI:1 AUTHORIZED PER SYSTEM)	
				END OF FIGURE	

SECTION IV

TM11-7440-283-20P

NATIONAL STOCK NUMBER AND PART NUMBER INDEX

STOCK NUMBER	NATIONAL STOCK NUMBER INDEX		FIG.	ITEM
	FIG.	ITEM		
5305-00-050-9227	0025	56		
5965-00-069-8886	0031	11		
8105-00-271-1511	32	69		
5355-00-559-8942	37	1		
	40	7		
	44	18		
5310-00-619-1148	0025	57		
6150-00-753-2014	0025	54		
6240-00-763-7744	0030	5		
6240-00-851-4352	0025	33		
5310-00-880-5978	0025	5		
5355-00-905-3518	0023	12		
5355-00-926-5238	0023	13		
	0027	16		
5965-01-104-0947	0031	10		
7025-01-121-1341	0029	2		
7025-01-122-2900	33	5		
7025-01-122-2907	33	9		
7025-01-122-2984	33	3		
7025-01-122-2985	33	4		
7025-01-122-3108	33	10		
7025-01-128-6410	33	8		
7025-01-128-6424	33	1		
7025-01-128-6425	33	2		
7025-01-130-4111	0003	7		
7025-01-130-4112	0003	5		
7025-01-130-4114	0016	4		
7025-01-130-4123	0003	1		
7025-01-130-4208	0003	14		
7025-01-130-4209	0003	18		
7025-01-130-4210	0003	19		
7025-01-130-4211	0003	20		
7025-01-130-4212	0003	12		
7025-01-130-4213	0003	21		
7025-01-130-4214	0003	15		
7025-01-130-4215	0003	16		
7025-01-130-4216	0003	13		
7025-01-130-4217	0003	17		
7025-01-132-5035	0003	6		
7025-01-134-2328	1	4		
7025-01-134-2329	1	2		
7010-01-134-2330	1	3		
7025-01-134-2331	1	1		
7035-01-134-3760	2	5		
7035-01-134-3761	2	2		
7035-01-134-3762	2	4		
7025-01-135-0026	2	3		
7021-01-135-0027	2	1		
5355-01-136-7167	0023	11		
6210-01-162-4493	0030	6		

SECTION IV TM11-7440-283-20P
 NATIONAL STOCK NUMBER AND PART NUMBER INDEX

FSCM	PART NUMBER INDEX PART NUMBER	STOCK NUMBER	FIG.	ITEM
56996	B4009141	7025-01-130-4112	0003	
56996	B4009150	7025-01-130-4208	0003	14
56996	B4009160	7025-01-130-4209	0003	18
56996	B4009170	7025-01-130-4210	0003	19
56996	B4009180	7025-01-130-4214	0003	15
56996	B4009190	7025-01-130-4212	0003	12
56996	B4009203		0003	10
56996	B4009205		0003	2
56996	B4009210	7025-01-130-4213	0003	21
56996	B4009220	7025-01-130-4216	0003	13
56996	B4009230	7025-01-130-4217	0003	17
56996	B4009240	7025-01-130-4215	0003	16
56996	B4009250	7025-01-130-4211	0003	20
56996	B4009260	7025-01-130-4123	0003	1
56996	B4009270	7025-01-130-4111	0003	7
56996	B4009290	7025-01-121-1341	0029	2
56996	B4009398-2	7025-01-122-2984	33	3
56996	B4009398-3	7025-01-122-2985	33	4
56996	B4009399-1	7025-01-128-6424	33	1
56996	B4009399-2	7025-01-128-6425	33	2
56996	B4009424		23	5
56996	B4009606-2		25	32
56996	B4009629-2		0003	4
			0003	11
			0025	46
56996	B4009704	7025-01-130-4114	0016	4
56996	B4009721		0032	4
56996	B4009723		0032	3
56996	B4009735-2		0023	53
56996	B4009735-4		0023	54
56996	B4009762		0023	3
56696	B4009947		0028	1
56696	B4009979		0028	2
56996	B4010001	7025-01-122-2900	33	5
56996	B4010002	7025-01-122-3108	33	10
56996	B4010039	7025-01-122-2907	33	9
56996	B4010043		33	6
56996	B4010048		33	7
56996	B4010085	7025-01-128-6410	33	8
56996	B4030165		0050	1
80058	CP-1317/GYK-29	7021-01-135-0027	2	1
81349	H-161D/U	5965-01-104-0947	0031	10
80058	H-189/GR	5965-00-069-8886	0031	11
80058	MK-1829/GYK-29	7035-01-134-3762	2	4
80058	MK-1831/GYK-29	7010-01-134-2330	1	3
80058	MK-1832/GYK-29	7025-01-134-2328	1	4
96906	MS15795-807	5310-00-880-5978	0025	5
96906	MS25083-3PB8	6150-00-753-2014	0025	54
96906	MS51957-61	5305-00-050-9227	0025	56
96906	MS91528-1EIG	5355-00-926-5238	0023	13
			0027	16

SECTION IV
 NATIONAL STOCK NUMBER AND PART NUMBER INDEX

TM11-7440-283-20P

FSCM	PART NUMBER INDEX PART NUMBER	STOCK NUMBER	FIG.	ITEM
96906	MS91528-1E2G	5355-00-905-3518	0023	12
96906	MS91528-1112G		0027	15
96906	MS91528-1114G	5355-01-136-7167	0023	11
96906	MS91528-1N1B	5355-00-559-8942	37	1
			40	7
			44	18
80058	MT-49381GYK-29	7035-01-134-3760	2	5
80058	OD-144(V)/GYK-29	7025-01-134-2329	1	2
80058	OL-200/GYK-29(V)	7025-01-134-2331	1	1
80058	ON-1881GYK-29	7025-01-135-0026	2	3
80058	RD-439/GYK-29	7035-01-134-3761	2	2
80063	SC-B-49729-7	8105-00-271-1511	32	69
81348	W-L-00111/7	6240-00-763-7744	0030	5
06424	WL111TRADE0330	6240-00-851-4352	0025	33
06424	0770-9	5310-00-619-1148	0025	57
51163	15000579	7025-01-132-5035	0003	6
70318	400B0816		0025	4
81349	5975-X07-8007		0029	5
76854	7-P50	6210-01-162-4493	0030	6

By Order of the Secretary of the Army:

Official:

JOHN A. WICKHAM JR.
General, United States Army
Chief of Staff

DONALD J. DELANDRO
Brigadier General, United States Army
The Adjutant General

Distribution:

To be distributed in accordance with special list.

RECOMMENDED CHANGES TO EQUIPMENT TECHNICAL PUBLICATIONS



THEN... JOT DOWN THE DOPE ABOUT IT ON THIS FORM. CAREFULLY TEAR IT OUT, FOLD IT AND DROP IT IN THE MAIL!

SOMETHING WRONG WITH THIS PUBLICATION?

FROM: (PRINT YOUR UNIT'S COMPLETE ADDRESS)
 Commander
 Stateside Army Depot
 ATTN: AMSTA-US
 Stateside, N.J. 07703-5007

DATE SENT
 10 July 1975

PUBLICATION NUMBER TM 11-5840-340-20P	PUBLICATION DATE 23 Jan 78	PUBLICATION TITLE Radar Set AN/PRC-76
--	-------------------------------	--

BE EXACT PIN-POINT WHERE IT IS				IN THIS SPACE TELL WHAT IS WRONG AND WHAT SHOULD BE DONE ABOUT IT:
PAGE NO	PARA-GRAPH	FIGURE NO	TABLE NO	
33				For item 2, change the NSN to read: 5835-00-134-9186. Reason: Accuracy.
44		19		Identify the cover on the junction box (item no. 5). Reason: It is a separate item and is not called out on figure 19.
45				Add the cover of the junction box as an item in the listing for figure 19. Reason: Same as above

S A M P L E

PRINTED NAME, GRADE OR TITLE, AND TELEPHONE NUMBER
 SSG I. M. DeSpirito of 999-1776

SIGN HERE

TEAR ALONG PERFORATED LINE

RECOMMENDED CHANGES TO EQUIPMENT TECHNICAL PUBLICATIONS



THEN...JOT DOWN THE DOPE ABOUT IT ON THIS FORM. CAREFULLY TEAR IT OUT, FOLD IT AND DROP IT IN THE MAIL.

SOMETHING WRONG WITH THIS PUBLICATION?

FROM: (PRINT YOUR UNIT'S COMPLETE ADDRESS)

DATE SENT

PUBLICATION NUMBER

TM 11-7440-283-20P

PUBLICATION DATE

28 May 1985

PUBLICATION TITLE

Battery Computer System
AN/GYK-29(V)

BE EXACT PIN-POINT WHERE IT IS

PAGE NO.	PARA-GRAPH	FIGURE NO.	TABLE NO.

IN THIS SPACE TELL WHAT IS WRONG AND WHAT SHOULD BE DONE ABOUT IT:

TEAR ALONG PERFORATED LINE

PRINTED NAME GRADE OR TITLE AND TELEPHONE NUMBER

SIGN HERE

DA FORM 2028-2
1 JUL 79

PREVIOUS EDITIONS ARE OBSOLETE

P.S.--IF YOUR OUTFIT WANTS TO KNOW ABOUT YOUR RECOMMENDATION MAKE A CARBON COPE OF THIS AND GIVE IT TO YOUR HEADQUARTERS.

FILL IN YOUR
UNIT'S ADDRESS

FOLD BACK

DEPARTMENT OF THE ARMY

OFFICIAL BUSINESS
PENALTY FOR PRIVATE USE \$300

POSTAGE AND FEES PAID
DEPARTMENT OF THE ARMY
DOD 314



TEAR ALONG PERFORATED LINE

Commander
US Army Communications-Electronics Command
and Fort Monmouth
ATTN: AMSEL-ME-MP
Fort Monmouth, NJ 07703-5007

THE METRIC SYSTEM AND EQUIVALENTS

WEIGHT MEASURE

1 Centimeter = 10 Millimeters = 0.01 Meters = 0.3937 Inches
 1 Meter = 100 Centimeters = 1000 Millimeters = 39.37 Inches
 1 Kilometer = 1000 Meters = 0.621 Miles

WEIGHTS

1 Gram = 0.001 Kilograms = 1000 Milligrams = 0.035 Ounces
 1 Kilogram = 1000 Grams = 2.2 lb.
 1 Metric Ton = 1000 Kilograms = 1 Megagram = 1.1 Short Tons

LIQUID MEASURE

1 Milliliter = 0.001 Liters = 0.0338 Fluid Ounces
 1 Liter = 1000 Milliliters = 33.82 Fluid Ounces

SQUARE MEASURE

1 Sq. Centimeter = 100 Sq. Millimeters = 0.155 Sq. Inches
 1 Sq. Meter = 10,000 Sq. Centimeters = 10.76 Sq. Feet
 1 Sq. Kilometer = 1,000,000 Sq. Meters = 0.386 Sq. Miles

CUBIC MEASURE

1 Cu. Centimeter = 1000 Cu. Millimeters = 0.06 Cu. Inches
 1 Cu. Meter = 1,000,000 Cu. Centimeters = 35.31 Cu. Feet

TEMPERATURE

$5/9(^{\circ}\text{F} - 32) = ^{\circ}\text{C}$
 212° Fahrenheit is equivalent to 100° Celsius
 90° Fahrenheit is equivalent to 32.2° Celsius
 32° Fahrenheit is equivalent to 0° Celsius
 $9/5^{\circ}\text{C} + 32 = ^{\circ}\text{F}$

APPROXIMATE CONVERSION FACTORS

TO CHANGE	TO	MULTIPLY BY
Inches	Centimeters	2.540
Feet	Meters	0.305
Yards	Meters	0.914
Miles	Kilometers	1.609
Square Inches	Square Centimeters	6.451
Square Feet	Square Meters	0.093
Square Yards	Square Meters	0.836
Square Miles	Square Kilometers	2.590
Acres	Square Hectometers	0.405
Cubic Feet	Cubic Meters	0.028
Cubic Yards	Cubic Meters	0.765
Fluid Ounces	Milliliters	29.573
its	Liters	0.473
arts	Liters	0.946
allons	Liters	3.785
Ounces	Grams	28.349
Pounds	Kilograms	0.454
Short Tons	Metric Tons	0.907
Pound-Feet	Newton-Meters	1.356
Pounds per Square Inch	Kilopascals	6.895
Miles per Gallon	Kilometers per Liter	0.425
Miles per Hour	Kilometers per Hour	1.609

TO CHANGE	TO	MULTIPLY BY
Centimeters	Inches	0.394
Meters	Feet	3.280
Meters	Yards	1.094
Kilometers	Miles	0.621
Square Centimeters	Square Inches	0.155
Square Meters	Square Feet	10.764
Square Meters	Square Yards	1.196
Square Kilometers	Square Miles	0.386
Square Hectometers	Acres	2.471
Cubic Meters	Cubic Feet	35.315
Cubic Meters	Cubic Yards	1.308
Milliliters	Fluid Ounces	0.034
Liters	Pints	2.113
Liters	Quarts	1.057
ers	Gallons	0.264
ms	Ounces	0.035
ograms	Pounds	2.205
Metric Tons	Short Tons	1.102
Newton-Meters	Pounds-Feet	0.738
Kilopascals	Pounds per Square Inch	0.145
ometers per Liter	Miles per Gallon	2.354
ometers per Hour	Miles per Hour	0.621

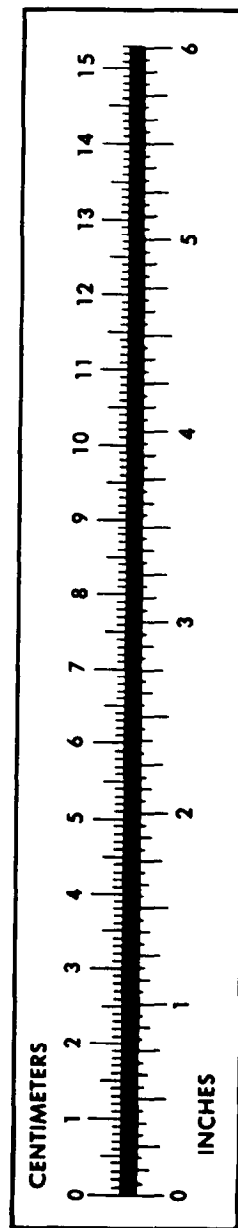

PIN: 057918-000